



MARSHALLWHITE

28 Hedderwick Street
Balwyn North



Stylish and Charming Family Living

Impressively renovated and imaginatively extended to fully capitalise on its expansive (822sqm approx.) private garden allotment, this picturesque mid-century home offers beautifully appointed family accommodation including charming formal living and dining rooms, modern kitchen with adjacent meals area opening to sheltered alfresco entertaining area, large main bedroom with luxurious ensuite, two further double bedrooms, modern family bathroom, two studies and a magnificent family room/home cinema.

3 2 2

Auction Saturday 22nd September at 10.30am

Stephen Gough
0439 844 855

Doug McLauchlan
0418 377 718

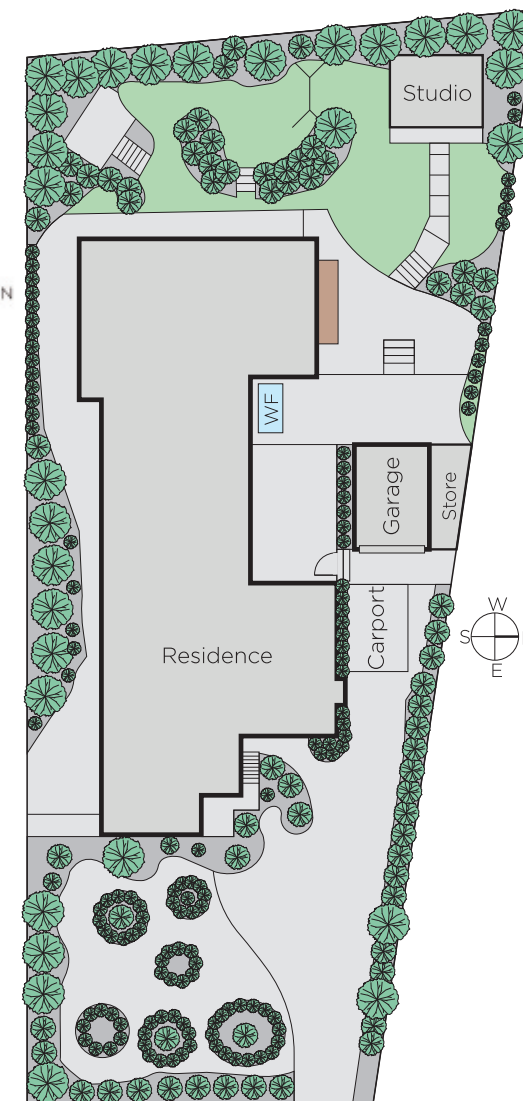

MARSHALLWHITE

801 Glenferrie Road, Hawthorn

Disclaimer: Information provided is believed to be accurate as at the date of printing, no responsibility is taken for any errors or omissions. It is your responsibility to obtain independent, professional advice. Personal information collected from you is for security purposes and to contact you should the property sell prior to auction. We may use this information to provide you with other real estate services including referrals to authorised financial services providers. Visit our website at www.marshallwhite.com.au for our privacy policy.