



MARSHALLWHITE
ONE

27/69 Palmer Street
Richmond



Inner City Luxury in the Heart of Richmond

This sophisticated, spacious two bedroom, inner-urban apartment enjoys a privileged position in the highly-regarded 'Nexus' building, where the emphasis is on blending five-star, resort-style luxury with a city-fringe lifestyle experience. A funky, angular design helps to cast this extraordinary apartment apart from others, as its elegant, Miele-equipped and stone-topped kitchen/meals/living spills effortlessly outdoors to a sun-drenched balcony. With glimpses of the CBD as its background and the swimming pool as its foreground, the promise here is of decadent al fresco living. The master bedroom offers semi-ensuite access to the vogue, fully-tiled bathroom in this home with secure video entry, two basement parking spaces, a storage cage, European laundry, robes in each bedroom and split system heating/cooling. Just metres from Bridge Rd and Victoria Gardens with city-bound trams, the Sports and Arts precincts are also moments away.

27-69palmerstreet-richmond.com

2 1 2

Auction Saturday 26th October at 2pm

James Hill 0402 421 154

Samantha Paterson 0417 137 721

Ash Sachdev 0402 425 661

801 Glenferrie Road Hawthorn

9822 9999 mwone.com.au

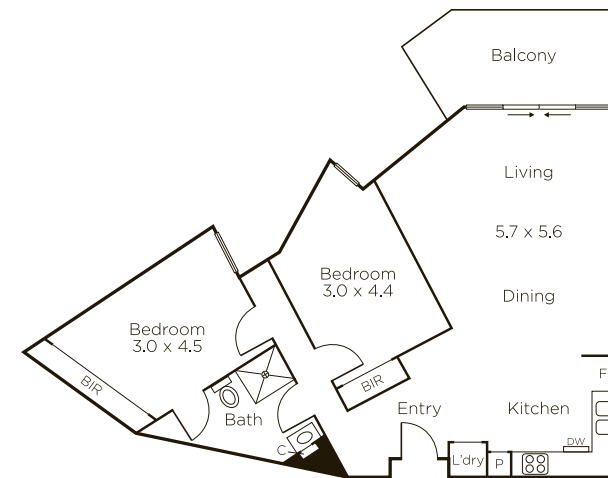

Storage
(Not In Position)

Carspace
(Not In Position)



MARSHALLWHITE
ONE

Disclaimer: Information provided is believed to be accurate as at the date of printing, no responsibility is taken for any errors or omissions. It is your responsibility to obtain independent, professional advice. Personal information collected from you is for security purposes to contact you should the property sell prior to auction. We may use this information to provide you with other real estate services including referrals to authorized financial services' providers. Visit our website at www.mwone.com.au for our privacy policy.