



MARSHALLWHITE

26 Boston Avenue
Malvern East



Utterly Captivating Inside and Out

Picturesque garden and pool surrounds, a sensational Pleysier Perkins designed extension and an enviable location near schools, transport and parks brilliantly enhance the sensational family focus of this stunning period residence. Lined timber floors flow through the wide hall to a gorgeous sitting room (open fire), main bedroom with walk in robe and en-suite/bathroom, three additional bedrooms (built in robes) and 2nd bathroom/laundry. The expansive living/dining room and gourmet kitchen open to the private northeast landscaped garden with pool. Includes alarm, powder-room, irrigation, water tank and OSP. Land: 664sqm (approx)

26bostonavenue-malverneast.com

4 2 2

Auction Saturday 6th May at 10.30am

John Manton 0411 444 930

Fiona Ansell-Jones 0410 325 240

Antony Woodley 0421 286 741

1111 High Street Armadale
marshallwhite.com.au

MARSHALLWHITE

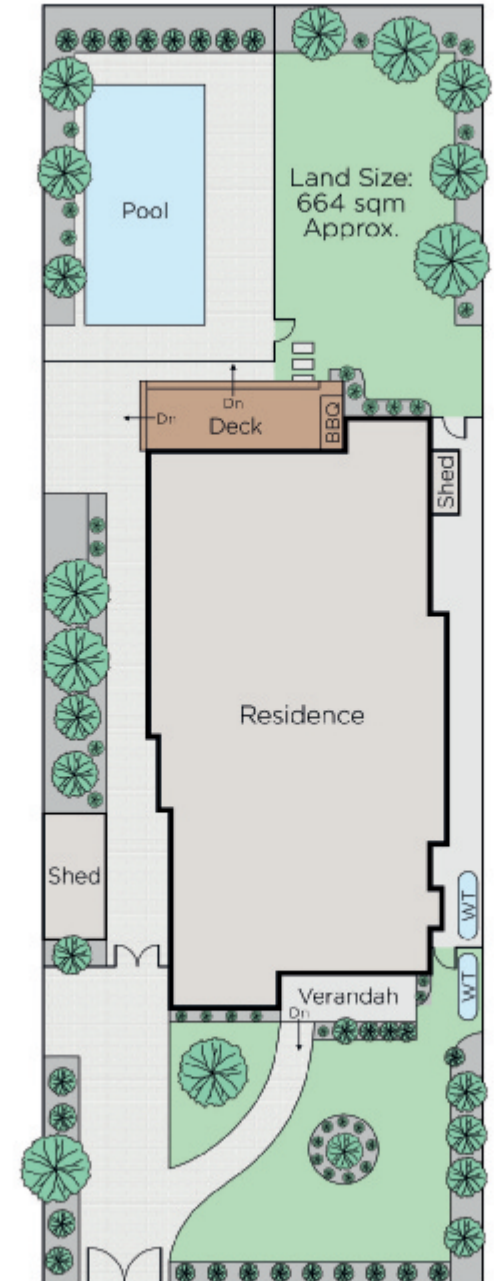

Disclaimer: Information provided is believed to be accurate as at the date of printing, no responsibility is taken for any errors or omissions. It is your responsibility to obtain independent, professional advice. Personal information collected from you is for security purposes and to contact you should the property sell prior to auction. We may use this information to provide you with other real estate services including referrals to authorised financial services' providers. Visit our website at www.marshallwhite.com.au for our privacy policy.