



MARSHALLWHITE
ONE

25/178 Power Street
Hawthorn



Vibrant Urban Living meets Delightful Tranquility

North-facing with an incredible sense of sanctuary, this bright, second floor / top floor, two bedroom home is not only well-removed from the street, but is also set amidst beautiful gardens with pretty parkland outlooks. Beautifully presented throughout and without up-stairs neighbours, the home features a kitchen / meals with appealing stone bench tops and timber cabinetry, as well as a bright lounge / dining that opens to a sun-drenched north-facing balcony. Ready to be lived-in or let, the home is immaculate with secure intercom entry and undercover parking, robes in each bedroom, a bathroom / laundry that is separate to the wc and the convenience of communal bike storage. Barely five kilometres from the city centre and with a tram at its doorstep, this outstanding home delivers you the rare combination of a dynamic inner-urban lifestyle and a peaceful sense of escape.

25-178powerstreet-hawthorn.com

2 1 1

Auction Saturday 23rd September at 10.30am

Bethany Wilkinson 0449 285 813

801 Glenferrie Road Hawthorn

Danny See 0402 533 853

9822 9999 mwone.com.au

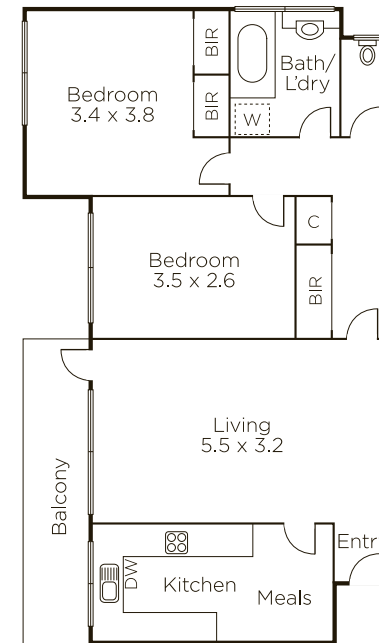

MARSHALLWHITE
ONE

Disclaimer: Information provided is believed to be accurate as at the date of printing, no responsibility is taken for any errors or omissions. It is your responsibility to obtain independent, professional advice. Personal information collected from you is for security purposes to contact you should the property sell prior to auction. We may use this information to provide you with other real estate services including referrals to authorized financial services' providers. Visit our website at www.mwone.com.au for our privacy policy.