



MARSHALLWHITE
ONE

2/46 Brougham Street
Kew



'Brougham Court': Superb Garden Apartment

With its own private north-facing garden, this spacious, two bedroom, older-style apartment in a block of four, is like few other urban pads. Huge windows draw in natural light and create a beautiful garden connection as the home's bright lounge room flows to a sunny balcony and the garden. Combining the joy of its leafy vistas with much less maintenance than a house, the home also features robes in each bedroom and polished timber floors, plus secure intercom entry, storage shed and parking. As functional and well-presented as they are, the kitchen and bathroom also present the opportunity to introduce your own style - at your leisure - to reap some serious rewards. Within seven kilometres of the CBD, Kew Junction is metres away and combines easy city access via trams and buses with an amazing café culture, strip shopping, bars and fine restaurants, as well as easy access to Yarra Boulevard, Studley Park and the Eastern Freeway.

2-46broughamstreet-kew.com

2 1 1

Auction Saturday 23rd February at 1.30pm

Ash Sachdev 0402 425 661

James Hill 0402 421 154

801 Glenferrie Road Hawthorn

9822 9999 mwone.com.au

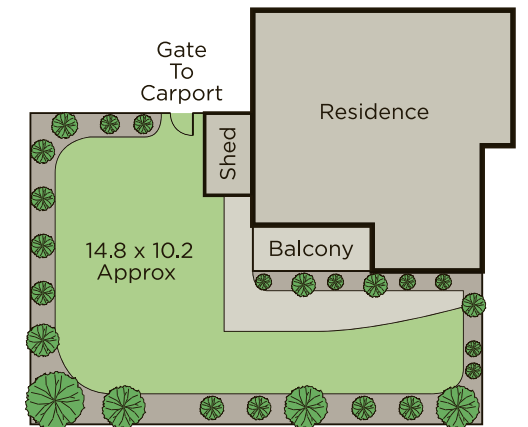
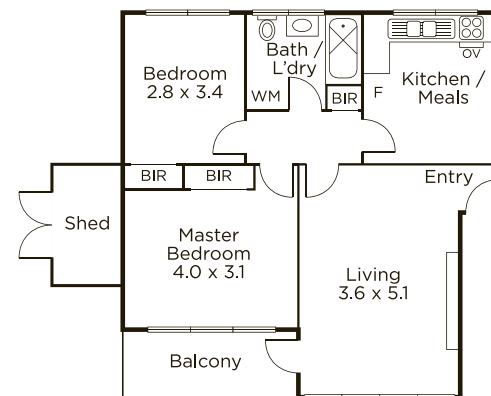

MARSHALLWHITE
ONE

Disclaimer: Information provided is believed to be accurate as at the date of printing, no responsibility is taken for any errors or omissions. It is your responsibility to obtain independent, professional advice. Personal information collected from you is for security purposes to contact you should the property sell prior to auction. We may use this information to provide you with other real estate services including referrals to authorized financial services providers. Visit our website at www.mwone.com.au for our privacy policy.