



472sqm
(approx.)

MARSHALLWHITE

24 Moore Street
Brighton East



Renovation or Brilliant New Build Opportunity

Ready for a grand-scale transformation, this classic home offers an exciting opportunity metres from Landcox Park and in the Gardenvale Primary School zone. Families love this central location, as it's an easy walk to North Brighton station, shops in Bay St, and cafes. Concept plans pending approval blend the best in contemporary style with original character. These can be yours to fast-track building a new home, or bring your own vision to this sought after address. Three levels of fine design incorporate four living areas including a basement games room, four bedrooms, two-room kitchen, and a pool.

24moorestreet-brightoneast.com

4 1 2

Auction Sunday 3rd June at 11.30am

Barb Gregory
0419 568 370

Alyce Fleming
0499 082 614

Simone Tindall
0408 330 355

MARSHALLWHITE

225 Bay Street, Brighton

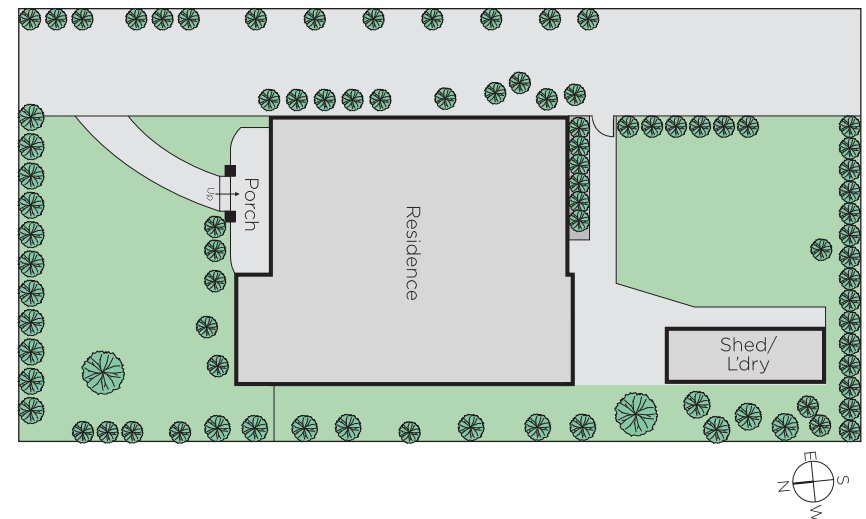
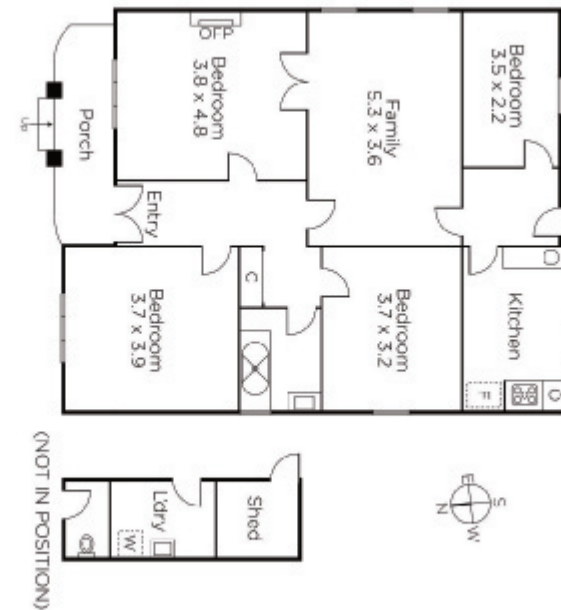

Disclaimer: Information provided is believed to be accurate as at the date of printing, no responsibility is taken for any errors or omissions. It is your responsibility to obtain independent, professional advice. Personal information collected from you is for security purposes and to contact you should the property sell prior to auction. We may use this information to provide you with other real estate services including referrals to authorised financial services providers. Visit our website at www.marshallwhite.com.au for our privacy policy.