



MARSHALLWHITE

2/320 Cotham Road
Kew



Classic Charm, Central Location

This ground floor two-bedroom apartment embraces traditional charm and presents a private oasis in a boutique block of just six. Boasting a timeless façade and spacious interiors including a formal sitting room with gas fireplace and outlooks towards a north-facing courtyard with a large timber deck and garden, family dining room with a study nook and a luxury kitchen featuring European appliances, pantry and rear access. The main bedroom comprises built-in robes and the second bedroom has convenient side access. Additional features include a central and well-equipped bathroom and off-street parking.

2-320cothamroad-kew.com

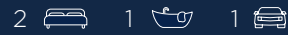

Auction Saturday 13th May at 12.30pm

Samara Bella-Coulson 0488 111 915

Doug McLauchlan 0418 377 718

801 Glenferrie Road Hawthorn

marshallwhite.com.au

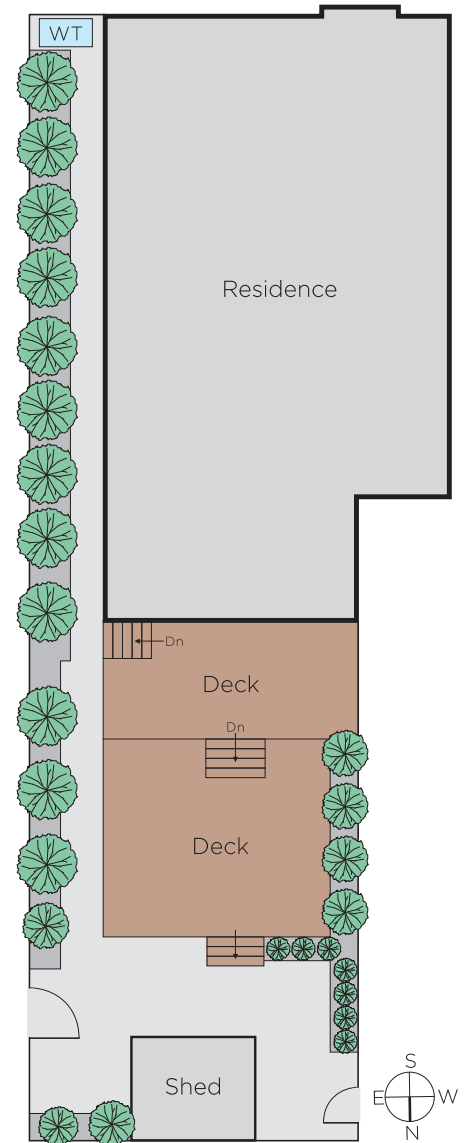
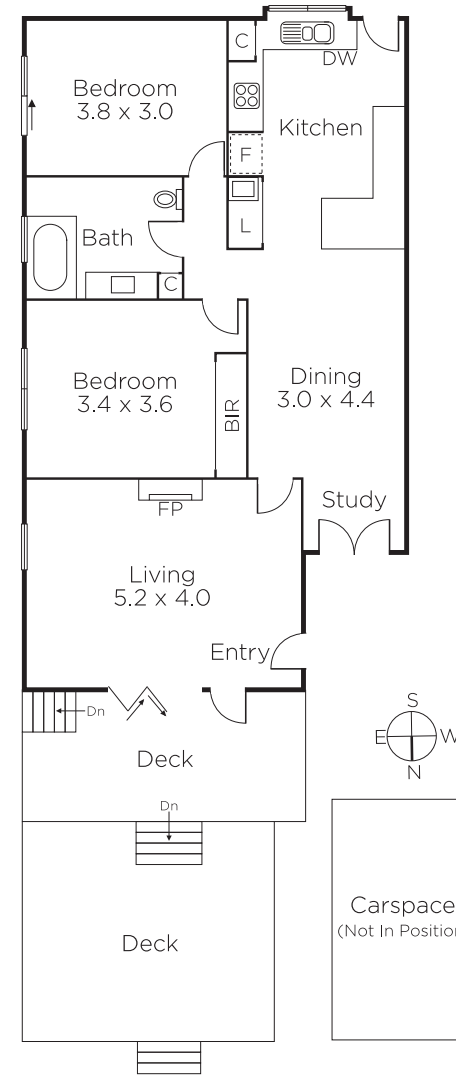

Disclaimer: Information provided is believed to be accurate as at the date of printing, no responsibility is taken for any errors or omissions. It is your responsibility to obtain independent, professional advice. Personal information collected from you is for security purposes and to contact you should the property sell prior to auction. We may use this information to provide you with other real estate services including referrals to authorised financial services' providers. Visit our website at www.marshallwhite.com.au for our privacy policy.