



MARSHALLWHITE  
ONE

2/247 Highfield Road  
Camberwell



## Sunny Villa with a Village Lifestyle

A relaxing home with a light-filled northern orientation, this beautifully presented, two bedroom villa is perfectly positioned for all buyers keen to enjoy a vibrant urban lifestyle. The home's kitchen/meals is a welcoming and casual space that overlooks a peaceful paved courtyard, while the lounge/dining is broad, north-facing and light-filled. Also features a master bedroom with semi-ensuite and walk-in robes, a double lock-up garage, ducted heating and cooling, plus ducted vacuum, brand new carpets, robes in the second bedroom and a full-size laundry. Just metres from the renowned Leo's Supermarket, shops and eateries of Hartwell Village and zoned for primary and secondary education, this diverse location also promises easy access to public transport, wonderful Lynden Park and Highfield Park, whilst Middle Camberwell Shopping Centre and Camberwell Junction are both just around the corner as well.

2-247highfieldroad-camberwell.com

2 1 2

Auction Saturday 30th March at 10am

Danny See 0402 533 853

Kane Penhalluriack 0406 556 445

801 Glenferrie Road Hawthorn

9822 9999 mwone.com.au

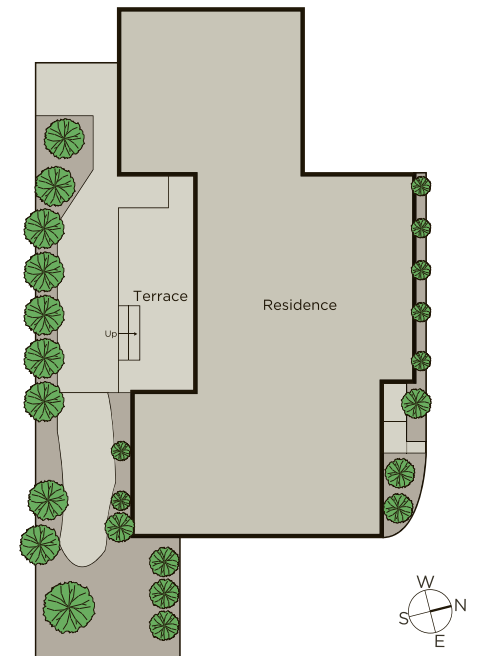

MARSHALLWHITE  
ONE

Disclaimer: Information provided is believed to be accurate as at the date of printing, no responsibility is taken for any errors or omissions. It is your responsibility to obtain independent, professional advice. Personal information collected from you is for security purposes to contact you should the property sell prior to auction. We may use this information to provide you with other real estate services including referrals to authorized financial services providers. Visit our website at [www.mwone.com.au](http://www.mwone.com.au) for our privacy policy.