



CUMULUS
6 LISSON GROVE

MARSHALLWHITE
ONE

223/6 Lisson Grove
Hawthorn



‘Cumulus’: Timeless Sophistication

This sleek, sophisticated and impressively sized, one bedroom apartment is an irresistible opportunity for savvy investors and lovers of a Glenferrie Rd lifestyle to acquire a secure home in the highly sought-after and cutting edge ‘Cumulus’ building.

As it transitions from an open-plan kitchen / meals / living to an attractive balcony, the home proudly highlights stone kitchen bench tops, superior Miele appliances, striking mirrored splash backs and lovely parquet floors. Also offering secure video entry, basement parking and storage, as well as substantial robes, reverse cycle air conditioning, a convenient bathroom / laundry and a fully landscaped garden the home is a pure joy to live in. Just a leisurely stroll from Glenferrie Rd’s renowned cafes, shops and a diversity of restaurants, this blue ribbon location of convenience also offers easy access to the city and Swinburne University.

223-6lissongrove-hawthorn.com

1 1 1

Private Sale

Bethany Wilkinson 0449 285 813
Jack Moss 0439 378 954

801 Glenferrie Road Hawthorn
9822 9999 mwone.com.au

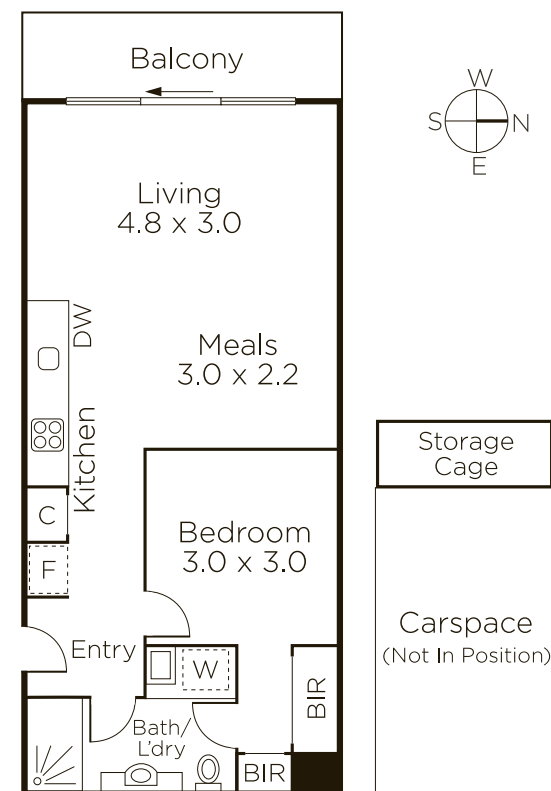

MARSHALLWHITE
ONE

Disclaimer: Information provided is believed to be accurate as at the date of printing, no responsibility is taken for any errors or omissions. It is your responsibility to obtain independent, professional advice. Personal information collected from you is for security purposes to contact you should the property sell prior to auction. We may use this information to provide you with other real estate services including referrals to authorized financial services providers. Visit our website at www.mwone.com.au for our privacy policy.