



MARSHALLWHITE

22 Westbrook Street
Kew East





Family Appeal with Future Potential

On the edge of Harp Village, near Hays Paddock, schools, tram, bus lines and freeway access, this charming single level period home is generously proportioned, light-filled and superbly presented. Dimensions offer immediate family appeal while its deep northeast facing allotment provides enormous scope to extend or rebuild (STCA).

Wonderful period features including Baltic pine floors and high ceilings characterize the L-shaped hall, gorgeous formal room with open fireplace and four bright double bedrooms accompanied by a bathroom and powder-room. The well appointed modern kitchen and spacious living and dining room open to the deep private and leafy northeast garden.

Ideal to enjoy now while considering the options, it also includes ducted heating, split system air conditioner, laundry, storage, cubby house, garden shed and off street parking.

22westbrookstreet-keweast.com

4  1  1 

Auction Saturday 18th November at 1.30pm

Shamit Verma 0401 137 597

Grayson Rayner 0433 654 744

801 Glenferrie Road Hawthorn

marshallwhite.com.au

MARSHALLWHITE

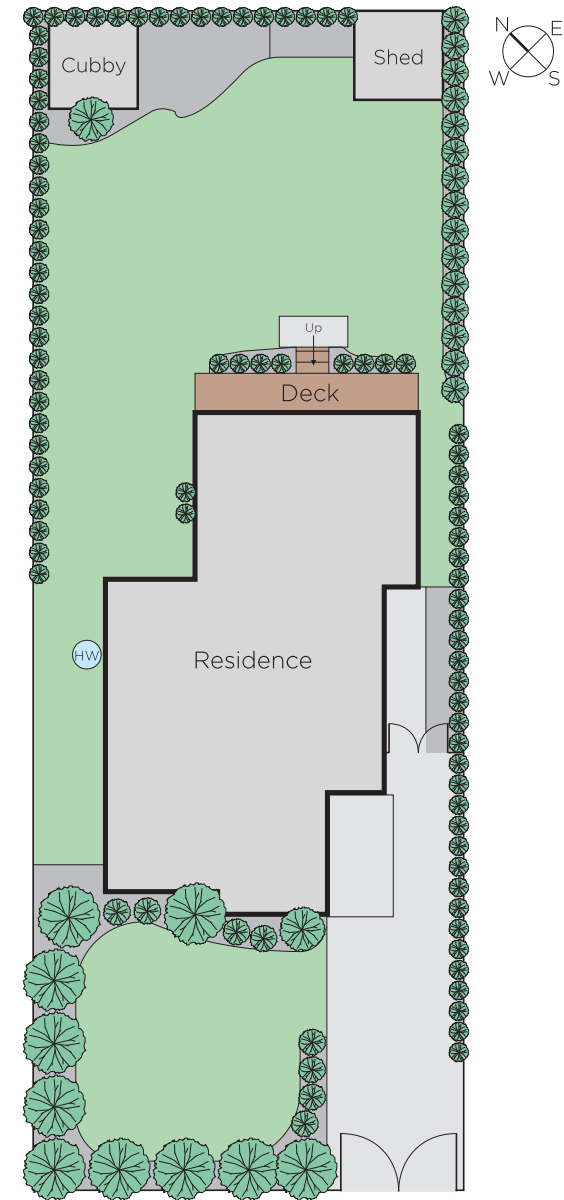

Disclaimer: Information provided is believed to be accurate as at the date of printing, no responsibility is taken for any errors or omissions. It is your responsibility to obtain independent, professional advice. Personal information collected from you is for security purposes and to contact you should the property sell prior to auction. We may use this information to provide you with other real estate services including referrals to authorised financial services' providers. Visit our website at www.marshallwhite.com.au for our privacy policy.