



1A



  
MARSHALLWHITE

2/1a Hartpury Avenue  
Elwood





## Elegant Living in an Elwood Locale

Presented in an elegant boutique block, this timeless and as-new two-bedroom residence in the heart of Elwood comprises generous proportions and details of the highest quality. The over-sized open-plan living and dining area is complete with a sizable balcony and complemented by a contemporary kitchen with stone benches and stainless steel appliances. Bedrooms are spacious and light-filled with garden views and built-in robes, and the main bedroom features an ensuite. A bathroom/laundry provides ample storage and luxury bathtub. Located on the first floor, this home offers the convenience of secure under cover parking on title.

2-1ahartpurysvenue-elwood.com

2 2 1

Auction Saturday 29th April at 11.30am

Kaine Lanyon 0411 875 478

Colette Valdock 0468 367 100

101 Dundas Place Albert Park  
marshallwhite.com.au

  
MARSHALLWHITE

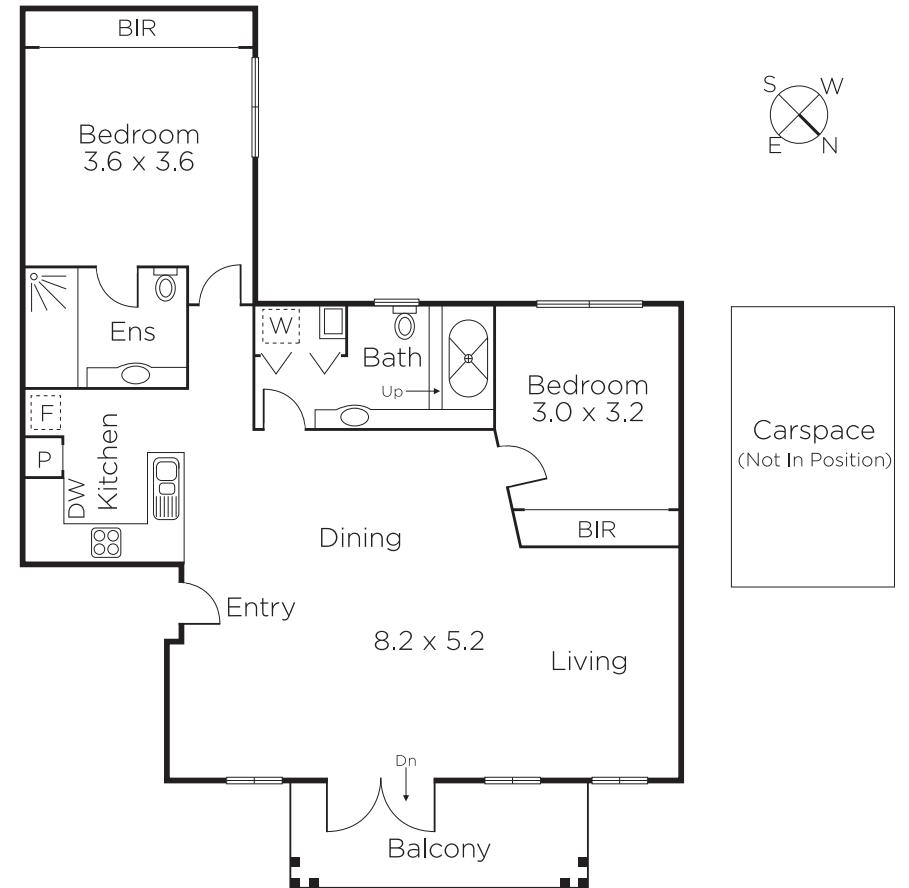

Disclaimer: Information provided is believed to be accurate as at the date of printing, no responsibility is taken for any errors or omissions. It is your responsibility to obtain independent, professional advice. Personal information collected from you is for security purposes and to contact you should the property sell prior to auction. We may use this information to provide you with other real estate services including referrals to authorised financial services' providers. Visit our website at [www.marshallwhite.com.au](http://www.marshallwhite.com.au) for our privacy policy.