



  
MARSHALLWHITE  
ONE

2/14 Mountfield Avenue  
Malvern East



## Peaceful Townhouse, Infused with Quality

Effortlessly chic and presented as new, this two-to-three bedroom executive townhouse is one of only two and free of any Body Corp fees. An open-plan kitchen / meals / living is bright with Caesarstone waterfall benches, volumes of soft close cabinetry, premium Bosch appliances and superior floor tiles as it flows outdoors to a sunny rear courtyard, whilst the master bedroom is blessed with a fully-tiled ensuite and walk-in robes. Upstairs, an additional living zone raises the enticing prospect of being used as a third bedroom or home office. Additional features include a lock-up garage, European laundry, easy care gardens, a water tank and reverse cycle air conditioning. Just around the corner from all the shops, cafes, restaurants and cinemas of Chadstone Shopping Centre, the home is also within metres of another shopping and café strip on Warrigal Rd, as well as Holmesglen Railway Station and Holmesglen Institute.

2-14mountfieldavenue-malverneast.com 2 2 1

Auction Saturday 4th May at 10am

Joseph Ben-Danan 0408 135 948

David Volpato 0414 701 983

Tom Hayne 0429 149 070

1111 High Street Armadale

9822 9999 mwone.com.au

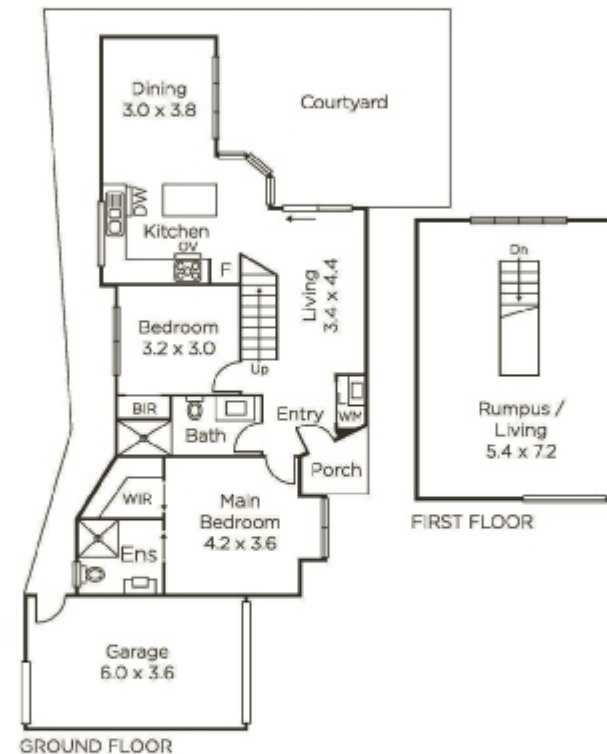

MARSHALLWHITE  
ONE

Disclaimer: Information provided is believed to be accurate as at the date of printing, no responsibility is taken for any errors or omissions. It is your responsibility to obtain independent, professional advice. Personal information collected from you is for security purposes to contact you should the property sell prior to auction. We may use this information to provide you with other real estate services including referrals to authorized financial services providers. Visit our website at [www.mwone.com.au](http://www.mwone.com.au) for our privacy policy.