



MARSHALLWHITE

203/127 Beach Street
Port Melbourne



Beachfront Living with Exceptional Convenience

Enjoying beach frontage between Princes and Station Piers, this apartment's generous dimensions are advantaged by a north-western orientation and city skyline views. A well-designed floor plan provides interconnected yet separate living and dining zones and a gourmet kitchen. The living spaces open out to a full width covered balcony. The main bedroom with built-in robes and ensuite also opens to the balcony. Impeccably presented while also providing scope to easily update, it includes video intercom, lift access, laundry, storage cage, basement car-spaces and access to the building's outdoor pool.

2 2 1

Private Sale

Sarah Wood
0408 902 827

Kaine Lanyon
0411 875 478

MARSHALLWHITE

101 Dundas Place, Albert Park

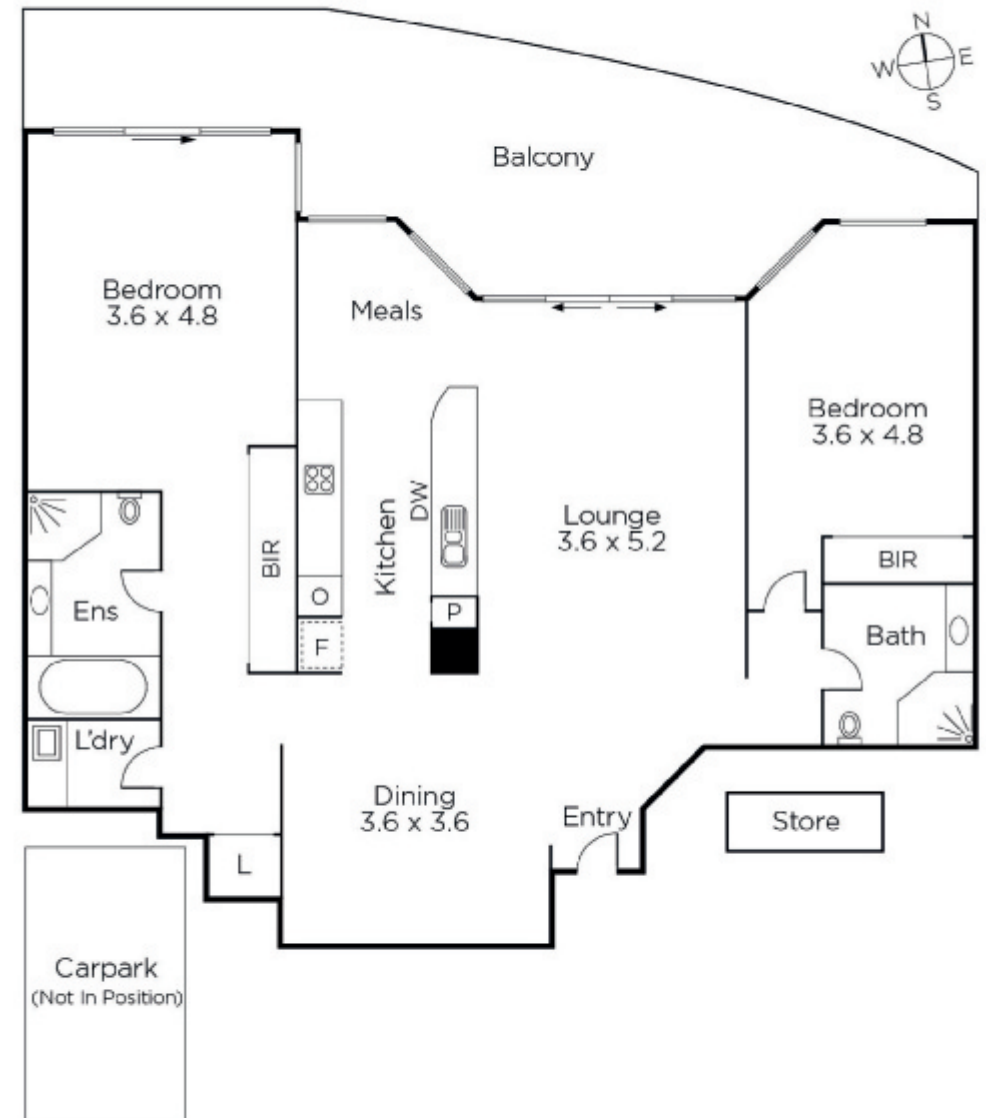

Disclaimer: Information provided is believed to be accurate as at the date of printing, no responsibility is taken for any errors or omissions. It is your responsibility to obtain independent, professional advice. Personal information collected from you is for security purposes and to contact you should the property sell prior to auction. We may use this information to provide you with other real estate services including referrals to authorised financial services providers. Visit our website at www.marshallwhite.com.au for our privacy policy.