



MARSHALLWHITE
ONE

201/795 Toorak Road
Hawthorn East



'The Anderson': City Views, Urban Sophistication

Framing fantastic views of Melbourne's ever-expanding city skyline, this brand new, sleek and sophisticated, two bedroom apartment is just metres from Tooronga Village Shopping Centre, freeway access and the ability to walk or ride along the pristine paths and parkland of the Gardiners Creek. An open-plan kitchen/meals/living opens to a generous balcony and reveals striking stone benches that complement a suite of Miele appliances, whilst each of the bedrooms has been customised with well-designed built-in robes and storage. The bathroom is something to behold with feature tiling, a wall-mounted floating vanity, a concealed cistern and a frameless screened shower in this highly secure apartment with video entry, basement parking and elevator access. Should you tire of the local cafes and shopping at Tooronga, you also have Camberwell Junction just around the corner, easy access to Tooronga Railway Station and the M1 Freeway.

201-795toorakroad-hawthorneast.com 2 1 1

Auction Saturday 19th October at 12noon

Samantha Paterson 0417 137 721

Ash Sachdev 0402 425 661

Laurence Murphy 0421 829 028

801 Glenferrie Road Hawthorn

9822 9999 mwone.com.au

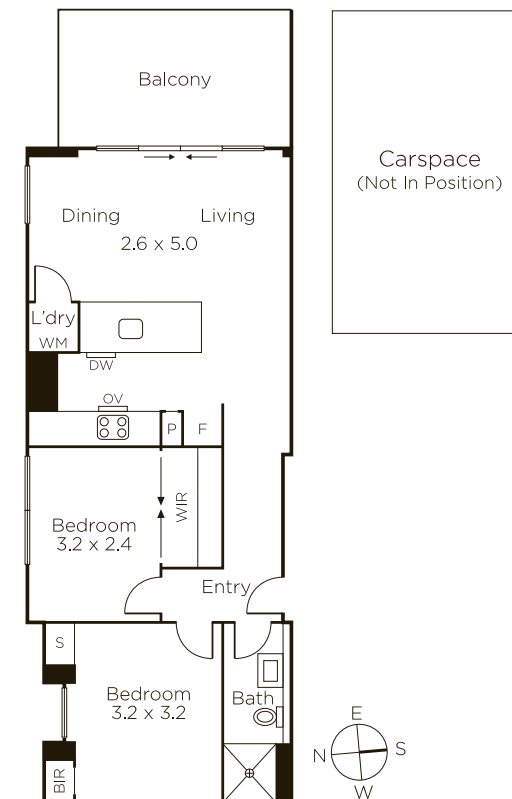

Disclaimer: Information provided is believed to be accurate as at the date of printing, no responsibility is taken for any errors or omissions. It is your responsibility to obtain independent, professional advice. Personal information collected from you is for security purposes to contact you should the property sell prior to auction. We may use this information to provide you with other real estate services including referrals to authorized financial services' providers. Visit our website at www.mwone.com.au for our privacy policy.