



  
MARSHALLWHITE  
ONE

201/2 Golding Street  
Hawthorn



## 'Atria': A Verdant Urban Sanctuary

Overlooking the lush privacy of the internal garden that differentiates the landmark 'Atria' building, this generously proportioned, single bedroom apartment offers a rare sense of sanctuary in the thriving heart of Hawthorn. Beautifully presented as new, the home's premium appointed kitchen highlights a stone waterfall bench, as open-plan living flows to a generous balcony that looks out onto the building's renowned garden, whilst secure video entry, basement parking and elevator access further enhance the joy of living here. Also features a stylish bathroom/laundry, built-in robes, a storage cage and split system heating/cooling. The selection of nearby cafes, restaurants, bars and strip shopping is first class, whilst you also have Lido Cinema within walking distance, Hawthorn Aquatic Centre just around the corner, trams on Glenferrie Rd and the easiest of city commuting via Glenferrie Railway Station as well.

201-2goldingstreet-hawthorn.com

1 1 1

### Private Sale

Ash Sachdev 0402 425 661

Samantha Paterson 0417 137 721

801 Glenferrie Road Hawthorn

9822 9999 mwone.com.au

  
MARSHALLWHITE  
ONE

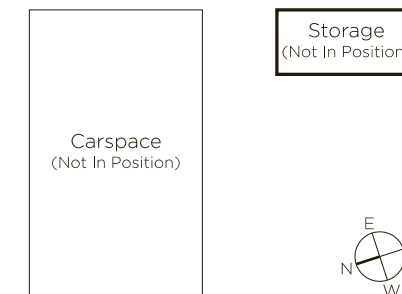
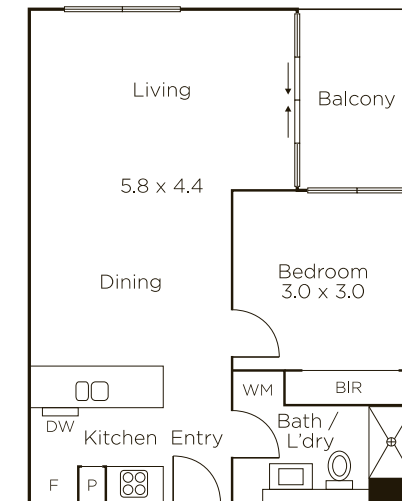

Disclaimer: Information provided is believed to be accurate as at the date of printing, no responsibility is taken for any errors or omissions. It is your responsibility to obtain independent, professional advice. Personal information collected from you is for security purposes to contact you should the property sell prior to auction. We may use this information to provide you with other real estate services including referrals to authorized financial services providers. Visit our website at [www.mwone.com.au](http://www.mwone.com.au) for our privacy policy.