



MARSHALLWHITE

20 Broomfield Road
Hawthorn East



"Fernleigh" - Victorian with Potential

This double-fronted Victorian family home, set within a beautiful tree lined cul-de-sac, presents a sensational opportunity to capitalise on recent refurbishing including painting, new carpets, restoration of OFPs & the addition of Plantation shutters. The fresh white interior offers an opportunity to take it to the next level with current permits in place for a single level extension. The accommodation currently features a Baltic Pine arched hallway, sitting/dining room, 3-bedrooms, newly renovated kitchen/meals, laundry and updated bathroom. Includes double garage/carport/OSP+ROW.

3 1 2

Auction Wednesday 12th December at 5.30pm

Andrew Gibbons
0407 577 007

Davide Lettieri
0414 018 707

Hamish Tostevin
0408 004 766

MARSHALLWHITE

801 Glenferrie Road, Hawthorn

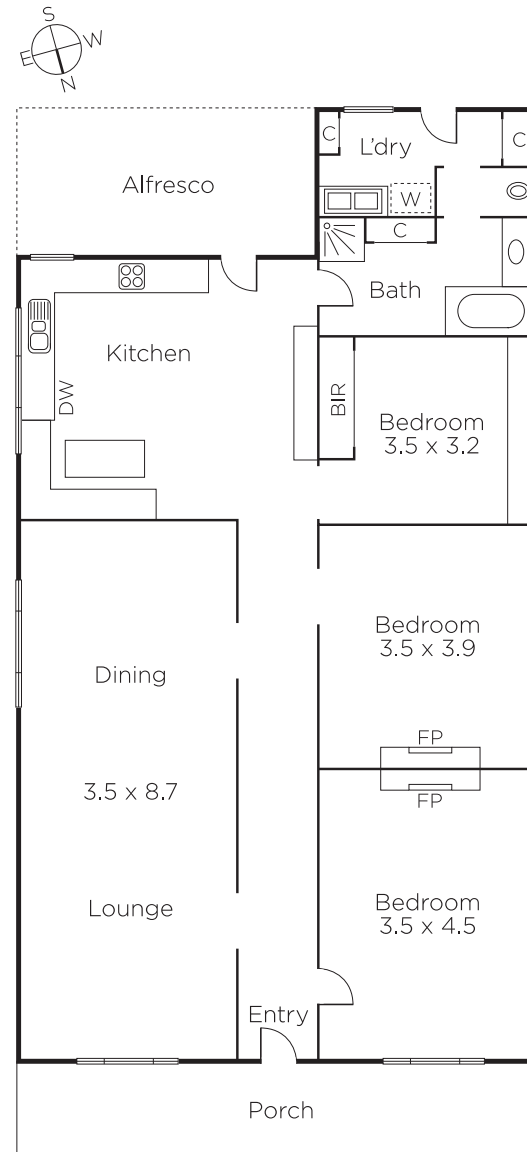

Disclaimer: Information provided is believed to be accurate as at the date of printing, no responsibility is taken for any errors or omissions. It is your responsibility to obtain independent, professional advice. Personal information collected from you is for security purposes and to contact you should the property sell prior to auction. We may use this information to provide you with other real estate services including referrals to authorised financial services providers. Visit our website at www.marshallwhite.com.au for our privacy policy.