



MARSHALLWHITE

20 Bidey Street
Prahran



Completely Captivating

At the end of a cul de sac yet only metres from Lumley Park & High Street's restaurants & shops, this charming Victorian residence's stylishly presented dimensions deliver instant lifestyle appeal. Baltic pine floors add to the character-rich ambience in the entrance hall, superbly appointed kitchen & the living/dining areas opening to a courtyard. A generous bedroom with BIR is downstairs while 2 double bedrooms with BIR's & a stylish bathroom are upstairs. Advantaged by 2 street frontages with entry from Closeburn Ave & includes laundry, 2nd toilet with under staircase storage & attic storage.

20bideystreet-prahran.com

3 1

Auction Saturday 21st April at 12.30pm

James McCormack
0410 503 389

Dean Gilbert
0418 994 939

Oliver Bruce
0409 856 599

MARSHALLWHITE

1111 High Street, Armadale

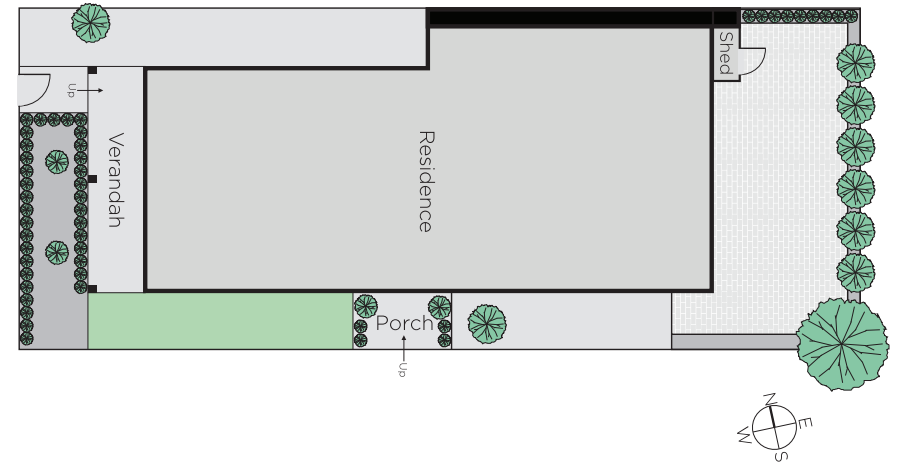
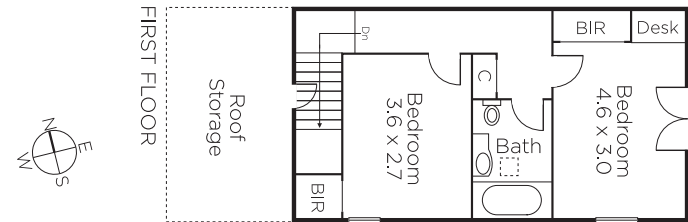
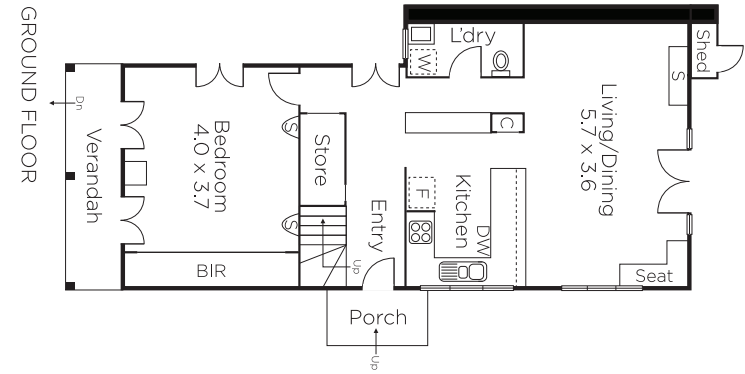

Disclaimer: Information provided is believed to be accurate as at the date of printing, no responsibility is taken for any errors or omissions. It is your responsibility to obtain independent, professional advice. Personal information collected from you is for security purposes and to contact you should the property sell prior to auction. We may use this information to provide you with other real estate services including referrals to authorised financial services providers. Visit our website at www.marshallwhite.com.au for our privacy policy.