



MARSHALLWHITE

2 Nicholson Street
South Yarra



Every Lifestyle Advantage

The immediate appeal of this charming period residence's superbly presented, light-filled dimensions is brilliantly enhanced by a location that puts Fawkner Park, Prahran Market, Chapel St, Toorak Rd, Sth Yarra station and schools all within an easy stroll. The bright central hall featuring an ornate ceiling leads to three double bedrooms which all open to the garden, and a bathroom. Timber floors flow through the inviting living room also with a decorative ceiling and open fireplace, a separate dining room and superb sky-lit kitchen opening to a garden retreat. Includes an alarm, laundry and OSP. Land: 230sqm (approx.)

3 1 1

Auction Saturday 27th October at 3.30pm

James McCormack
0410 503 389

Oliver Bruce
0409 856 599

MARSHALLWHITE

1111 High Street, Armadale

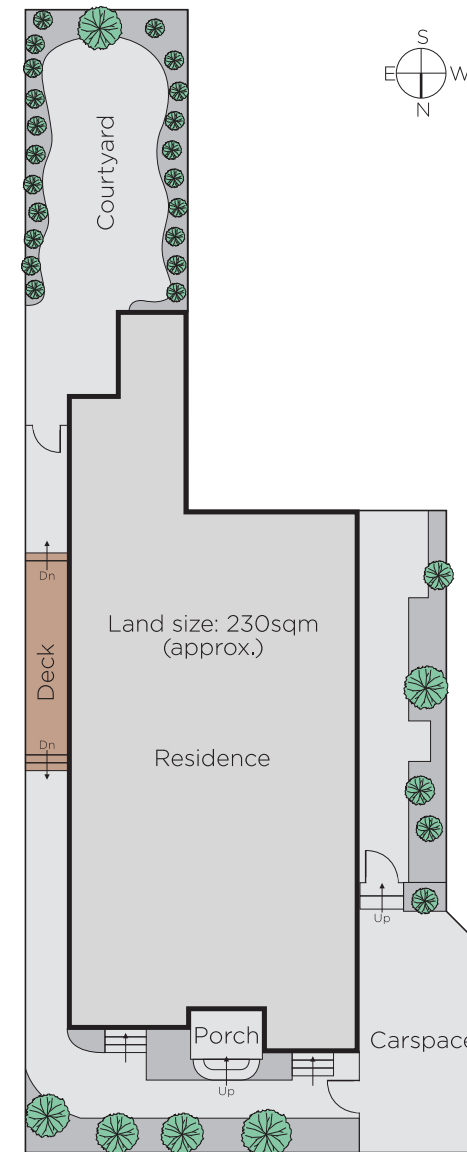
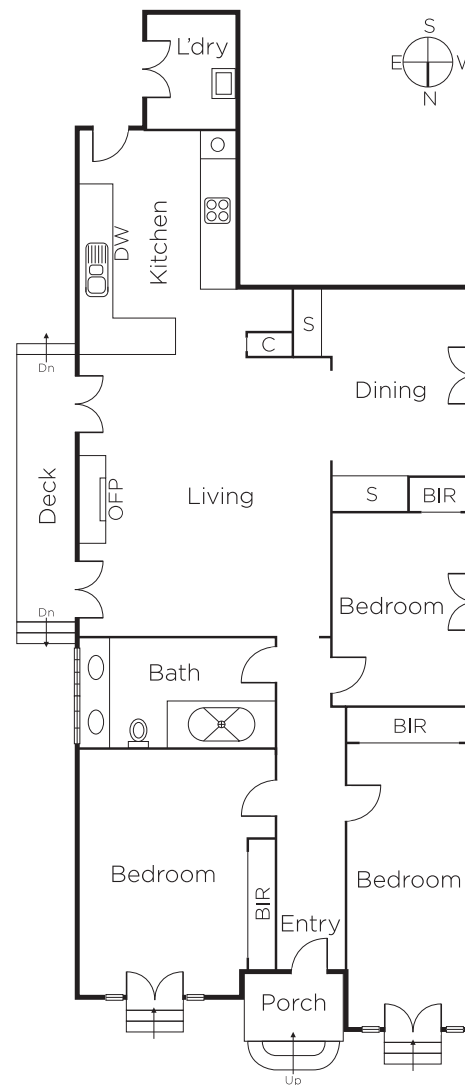

Disclaimer: Information provided is believed to be accurate as at the date of printing, no responsibility is taken for any errors or omissions. It is your responsibility to obtain independent, professional advice. Personal information collected from you is for security purposes and to contact you should the property sell prior to auction. We may use this information to provide you with other real estate services including referrals to authorised financial services providers. Visit our website at www.marshallwhite.com.au for our privacy policy.