



MARSHALLWHITE

2 Finch Street
Malvern East





"Churston" - c1907

A splendid example of Federation grandeur, this gracious c1907 residence showcases an impressive blend of classic and contemporary elegance in a premier Gascoigne Estate location close to trains, trams, shops and schools. Magnificent high ceilings and polished timber floors are a feature of the impressive hallway, sitting room, formal dining and study. A gourmet English kitchen and living/dining rooms open to the northeast garden. Generous accommodation comprises main bedroom with lavish en-suite, four additional bedrooms and a family bathroom. Includes separate laundry/3rd bathroom, auto gates, workshop, and two carports. Features plantation shutters, alarm, CCTV, ample storage and ducted vacuum. Land size: 807sqm approx.

2finchstreet-malverneast.com

5 3 2

Auction Saturday 24th February at 2.30pm

Anthony Reis
0417 352 774

Rae Tomlinson
0418 336 234

James Tomlinson
0408 350 684

MARSHALLWHITE

1111 High Street, Armadale

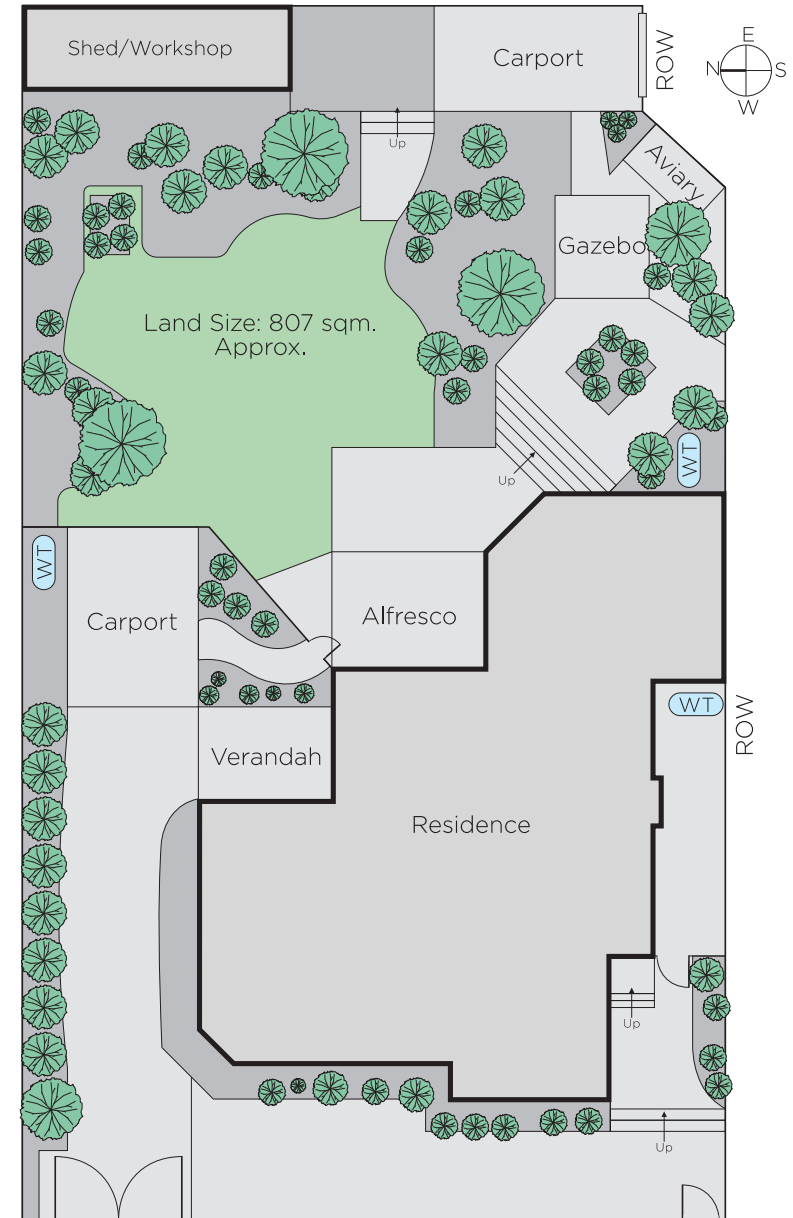
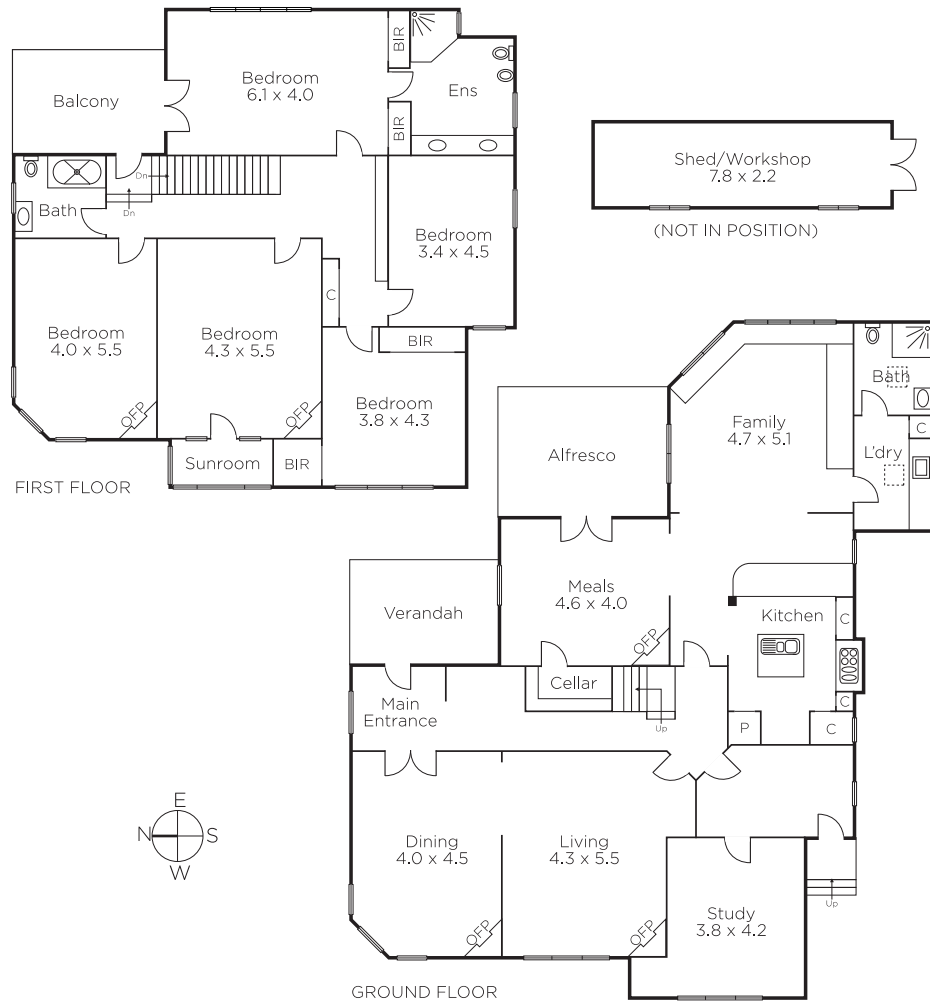

Disclaimer: Information provided is believed to be accurate as at the date of printing, no responsibility is taken for any errors or omissions. It is your responsibility to obtain independent, professional advice. Personal information collected from you is for security purposes and to contact you should the property sell prior to auction. We may use this information to provide you with other real estate services including referrals to authorised financial services' providers. Visit our website at www.marshallwhite.com.au for our privacy policy.