



MARSHALLWHITE

180 Station Street
Port Melbourne



Instant Appeal in Idyllic Locale

This impeccably presented classic double fronted Victorian residence delivers an irresistible inner-Bayside lifestyle. Located directly opposite parkland with a light rail stop and just moments from Bay St shops and restaurants, the beach and schools. Behind the evocative block-fronted façade, a wide arched central hall introduces two gorgeous bedrooms with built in robes, a third double bedroom with open fireplace and a bright, sky-lit bathroom. The superb modern kitchen and light-filled living and dining room open to a private sun-drenched paved garden courtyard. Perfect to just move in and enjoy, it also includes a laundry and 2nd toilet.

180stationstreet-portmelbourne.com

3 1.5

Auction Saturday 18th November at 10.30am

Justin Holod 0411 669 161

Sarah Wood 0408 902 827

101 Dundas Place Albert Park
marshallwhite.com.au

MARSHALLWHITE

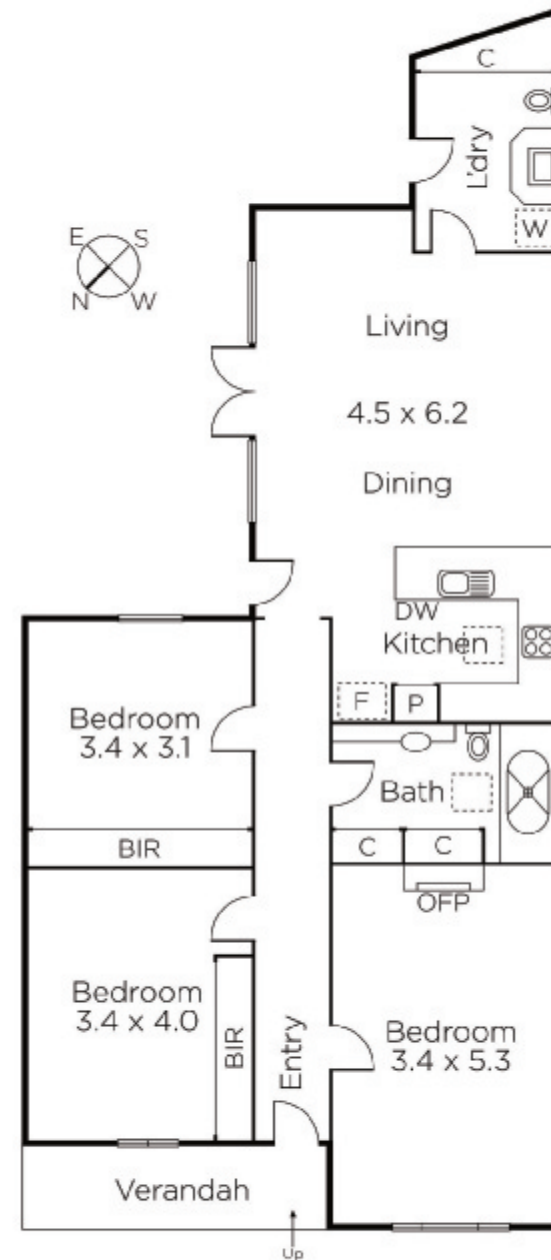

Disclaimer: Information provided is believed to be accurate as at the date of printing, no responsibility is taken for any errors or omissions. It is your responsibility to obtain independent, professional advice. Personal information collected from you is for security purposes and to contact you should the property sell prior to auction. We may use this information to provide you with other real estate services including referrals to authorised financial services' providers. Visit our website at www.marshallwhite.com.au for our privacy policy.