



MARSHALLWHITE

18 Greville Street
Pahran



Classic Charm, Coveted Location

The appeal of Victorian architecture is superbly evoked by the proportions of this classic double fronted residence. Idyllically situated near restaurants, shops, schools, Prahran station and market, its stylishly presented interior dimensions and flow are perfect for now while offering future scope (STCA).

The arched hallway introduces two generous bedrooms with marble open fires, third bedroom and stylish bathroom. Clerestory windows accentuate the light in the spacious living room (open fire). The modern kitchen and dining room open to the private west garden.

18grevillestreet-prahran.com

3 1 1

Auction Saturday 25th November at 2.30pm

Dean Gilbert 0418 994 939

James McCormack 0410 503 389

1111 High Street Armadale
marshallwhite.com.au

MARSHALLWHITE

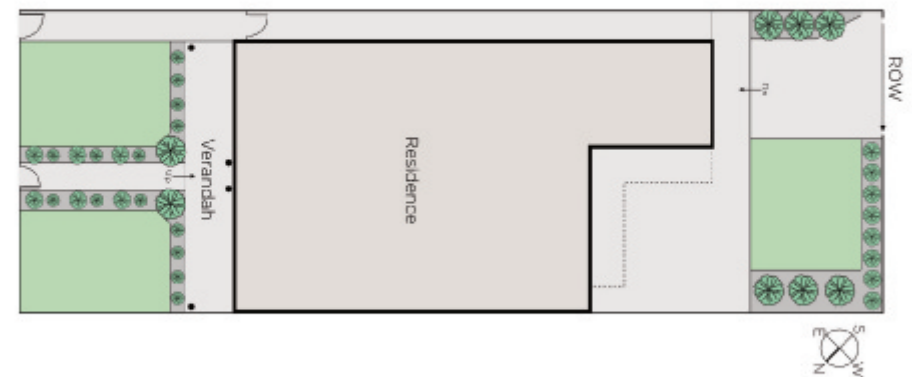
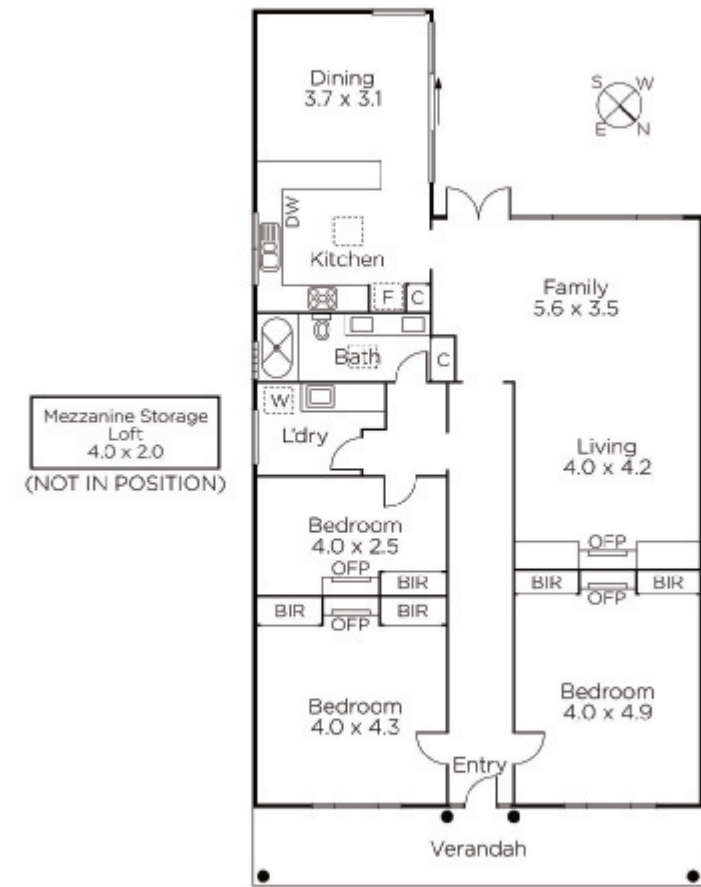

Disclaimer: Information provided is believed to be accurate as at the date of printing, no responsibility is taken for any errors or omissions. It is your responsibility to obtain independent, professional advice. Personal information collected from you is for security purposes and to contact you should the property sell prior to auction. We may use this information to provide you with other real estate services including referrals to authorised financial services' providers. Visit our website at www.marshallwhite.com.au for our privacy policy.