



MARSHALLWHITE

17 Milroy Street
Brighton East



Outstanding Potential on 735sqm

Potential and a prime location offer an exciting future and an exceptional opportunity a short stroll from Landcox Park. The land of 735 square metres approx is big enough for a grand plan STCA, in the Gardenvale Primary School zone and near Bay Street's shops, cafes and North Brighton station. Renovators will see the potential in "Grasmere" for fine family living. It's character-rich and comfortable with three bedrooms, three living areas, and a generous garden ready for a contemporary extension. Milroy Street is so well located, with a beautiful park and lake a few doors away, and cafes and many schools close by.

17milroystreet-brightoneast.com

3 1 2

Auction Saturday 28th April at 11.30am

Barb Gregory
0419 568 370

Simone Tindall
0408 330 355

Alyce Fleming
0499 082 614

MARSHALLWHITE

225 Bay Street, Brighton

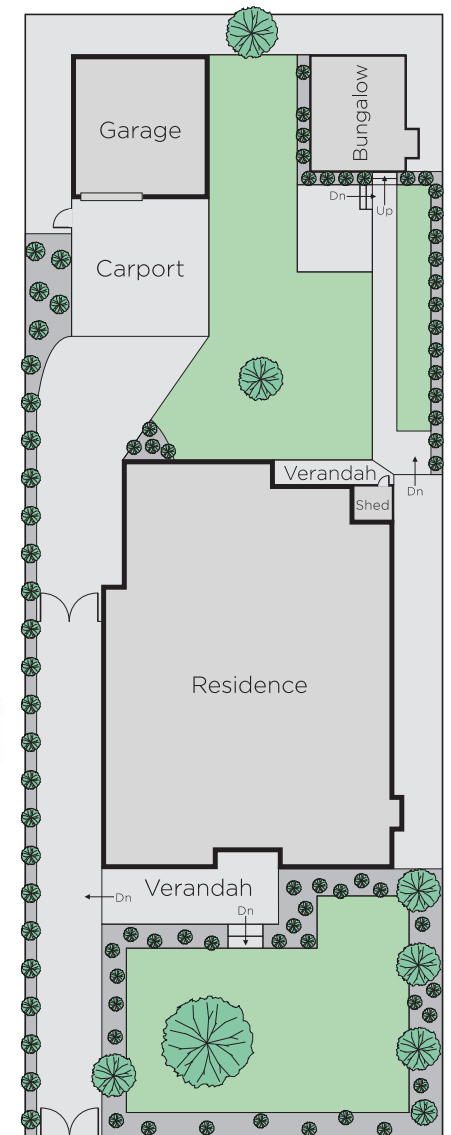
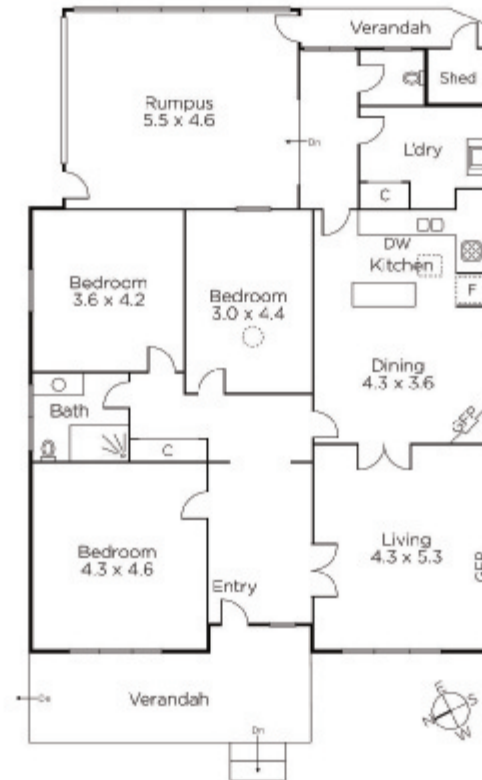

Disclaimer: Information provided is believed to be accurate as at the date of printing, no responsibility is taken for any errors or omissions. It is your responsibility to obtain independent, professional advice. Personal information collected from you is for security purposes and to contact you should the property sell prior to auction. We may use this information to provide you with other real estate services including referrals to authorised financial services providers. Visit our website at www.marshallwhite.com.au for our privacy policy.