



MARSHALLWHITE

1/60 Rathmines Road
Hawthorn East



A Place to Call Home

Modern single level home behind a pretty white picket fence offers a flexible F/P & light filled rooms. The home includes a sitting room/3rd bedroom, 2 additional bedrooms with BIR, large family bathroom, study & a gleaming white kitchen with S/S appliances & stone benchtops, open plan meals & family room flowing to large deck through a wall of windows. Beyond the deck is an easily maintained garden that can be accessed through ROW. Additional features include laundry room, split system A/C, ducted heating & attic. Just a short walk to parks, Auburn Primary, Auburn station & a plethora of shops along Auburn Road.

1-60rathminesroad-hawthorneast.com

3 1 2

Auction Saturday 24th March at 11.30am

Tori McGregor
0400 633 992

Michael Wood
0425 280 191

MARSHALLWHITE

801 Glenferrie Road, Hawthorn

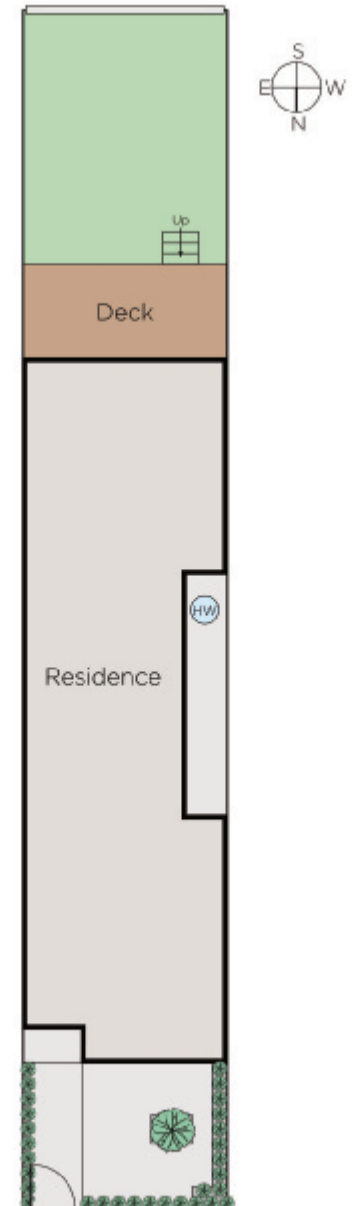
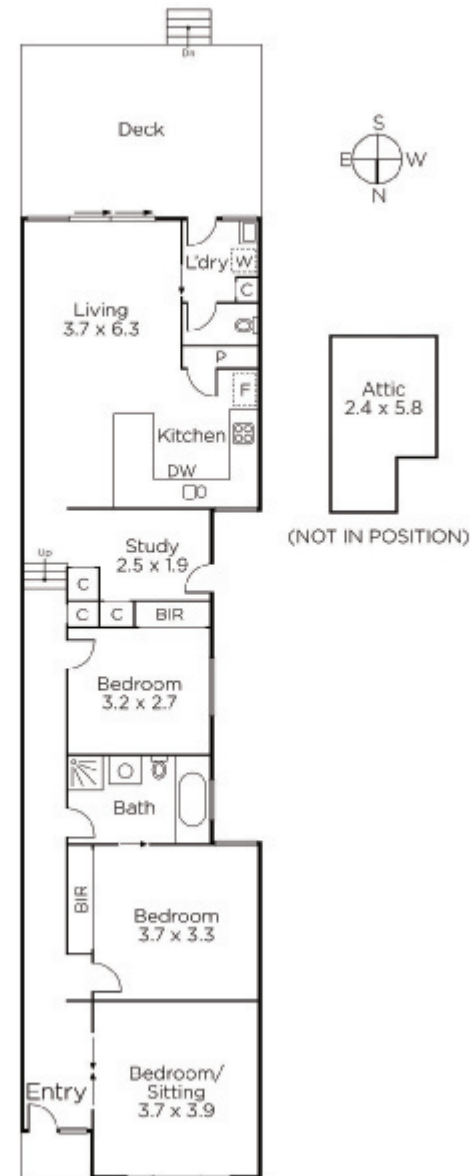

Disclaimer: Information provided is believed to be accurate as at the date of printing, no responsibility is taken for any errors or omissions. It is your responsibility to obtain independent, professional advice. Personal information collected from you is for security purposes and to contact you should the property sell prior to auction. We may use this information to provide you with other real estate services including referrals to authorised financial services providers. Visit our website at www.marshallwhite.com.au for our privacy policy.