



MARSHALLWHITE

16 Tooronga Road
Malvern East



Classic Edwardian on the Edge of the Gascoigne

Superbly situated within an exceptionally deep northeast garden, this charming Edwardian residence offers instant family appeal with scope to update and extend (STCA).

Baltic pine floors flow through the hall to the main bedroom with open fireplace, dressing room (open fire) and en-suite/bathroom, two additional bedrooms (open fires) and a bright bathroom. The inviting dining room with open fireplace, well-appointed kitchen and expansive living room open to the private garden.

On the fringe of the Gascoigne Estate walking distance to schools, Malvern and Caulfield stations, shops and Central Park. Land size: 711sqm approx.

16toorongaroad-malverneast.com

3 2 2

Auction Saturday 13th May at 9.30am

David Volpato 0414 701 983

James Redfern 0412 360 667

Anna Perry 0434 212 271

1111 High Street Armadale
marshallwhite.com.au

MARSHALLWHITE

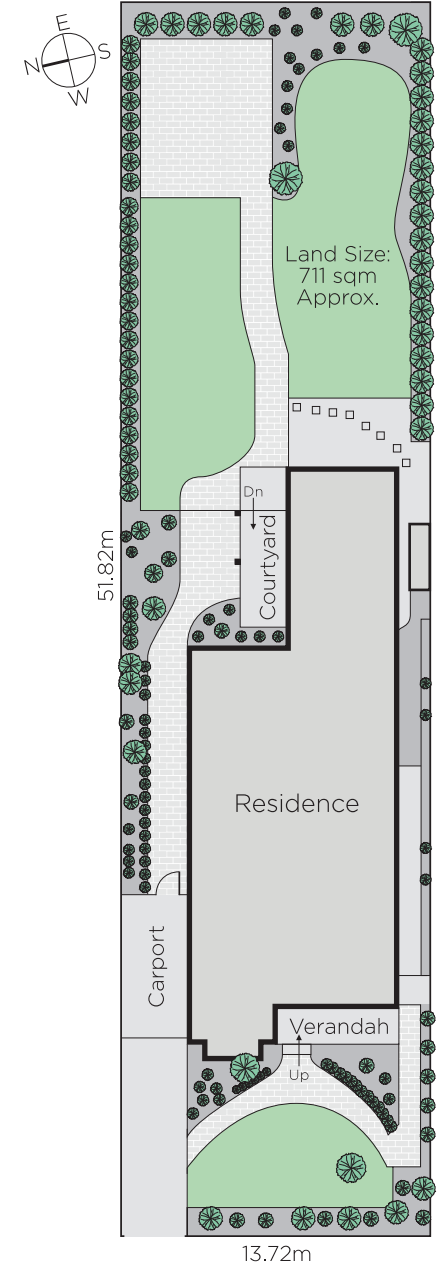
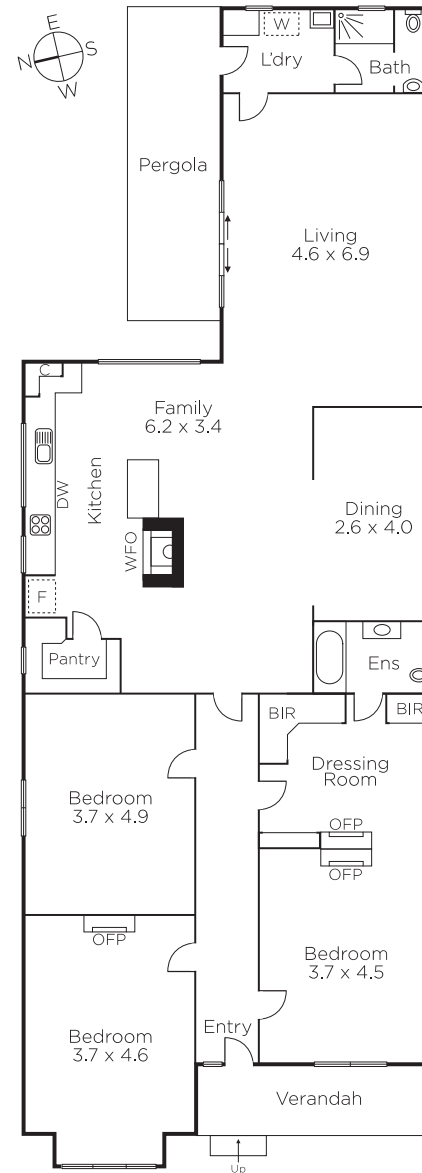

Disclaimer: Information provided is believed to be accurate as at the date of printing, no responsibility is taken for any errors or omissions. It is your responsibility to obtain independent, professional advice. Personal information collected from you is for security purposes and to contact you should the property sell prior to auction. We may use this information to provide you with other real estate services including referrals to authorised financial services' providers. Visit our website at www.marshallwhite.com.au for our privacy policy.