



MARSHALLWHITE

16 Fitzgerald Street
South Yarra



Victorian Allure, Vibrant Lifestyle

Enjoying a tranquil tree-lined cul de sac setting yet literally metres from Chapel St, Prahran Market, Sth Yarra station and trams, this enchanting block-fronted freestanding Victorian residence's superbly presented spaces offer immeasurable inner urban lifestyle appeal. An arched hallway flows through to two bright double bedrooms with built in robes and a pristine modern bathroom with Euro-laundry. Natural light streams through the spacious living and dining room and stylish well appointed kitchen opening to a private leafy garden with entertaining deck. Perfect to just move in and enjoy or as a rewarding investment.

16fitzgeraldstreet-southyarra.com

2 1

Auction Saturday 25th November at 1.30pm

Hugh Tomlinson 0409 427 483

James Tomlinson 0408 350 684

Samantha Kallend 0478 580 797

1111 High Street Armadale
marshallwhite.com.au

MARSHALLWHITE

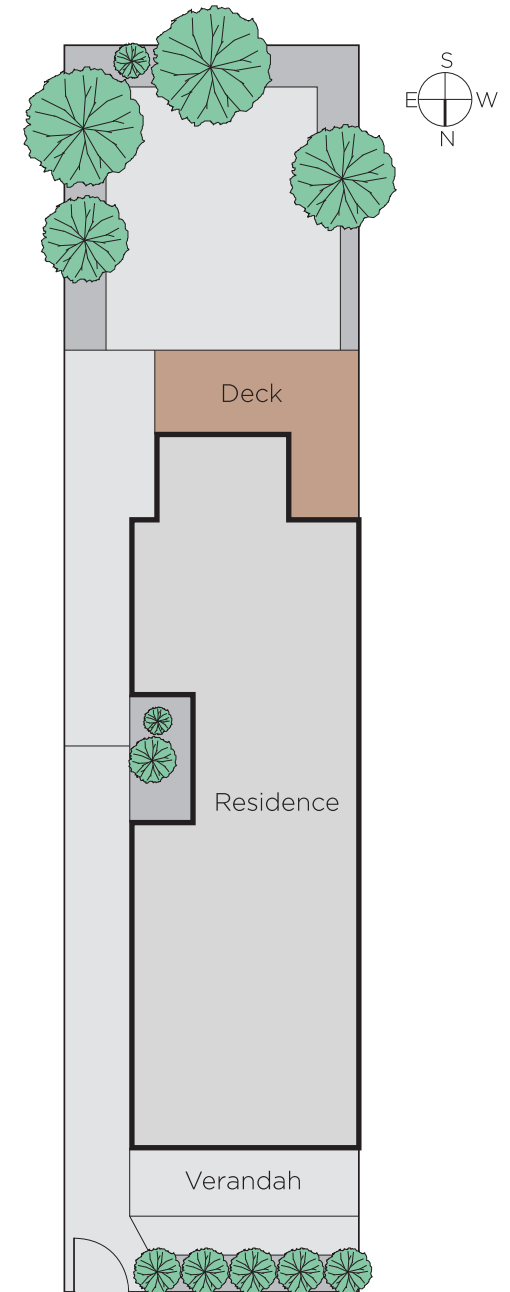
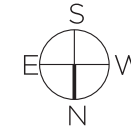
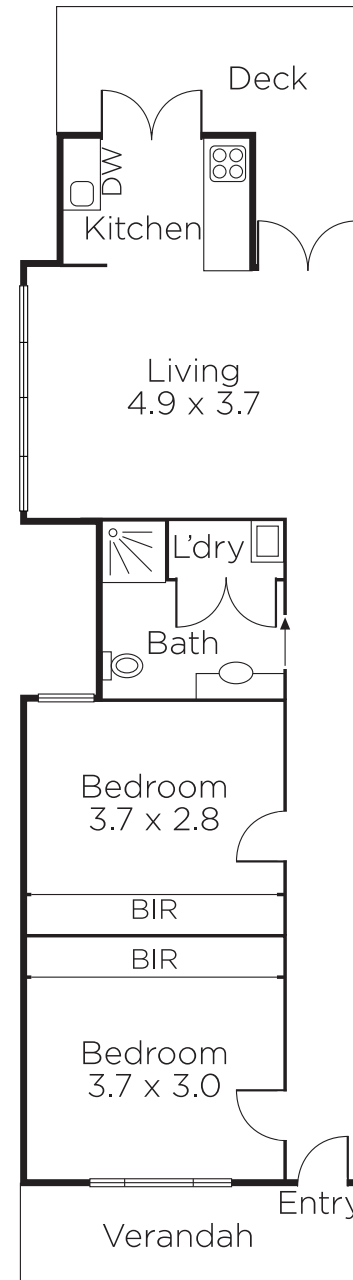

Disclaimer: Information provided is believed to be accurate as at the date of printing, no responsibility is taken for any errors or omissions. It is your responsibility to obtain independent, professional advice. Personal information collected from you is for security purposes and to contact you should the property sell prior to auction. We may use this information to provide you with other real estate services including referrals to authorised financial services' providers. Visit our website at www.marshallwhite.com.au for our privacy policy.