



MARSHALLWHITE

14a Hastings Road
Hawthorn East



More Than Meets the Eye

This deceptively spacious and recently refurbished home features an immaculate and stylish interior with a soft neutral toned décor and accommodation including an entrance foyer, sitting room with JetmasterFP, three double bedrooms all with BIRs, main+ensuite, bathroom (separate WC) and laundry. A smart galley-style kitchen is equipped with granite bench-tops, stainless steel stove and Miele dishwasher overlooking a sun-drenched north-west facing living/dining area; plus a paved courtyard garden. Other features include alarm, ducted heating & evaporative cooling, remote roller door and off-street parking if desired, accessed from a rear lane. Land size: 300sqm approx

14hastingsroad-hawthorneast.com

3 2.5 1

Auction Saturday 9th September at 11.30am

Hamish Tostevin 0408 004 766

Andrew Gibbons 0407 577 007

801 Glenferrie Road Hawthorn
marshallwhite.com.au

MARSHALLWHITE

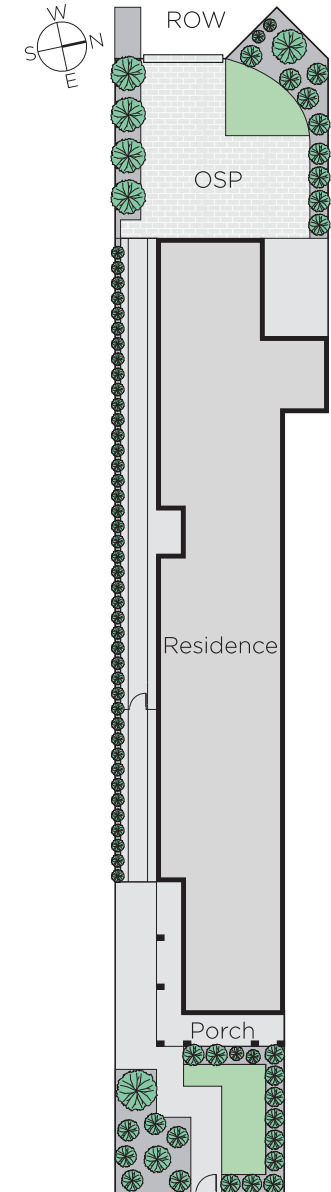
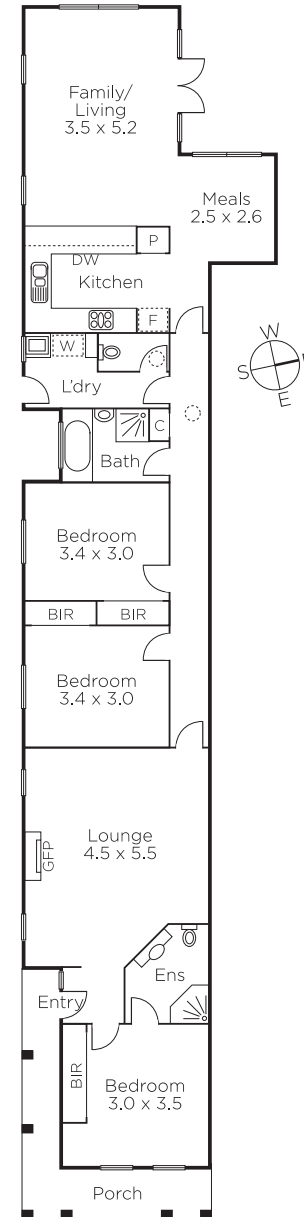

Disclaimer: Information provided is believed to be accurate as at the date of printing, no responsibility is taken for any errors or omissions. It is your responsibility to obtain independent, professional advice. Personal information collected from you is for security purposes and to contact you should the property sell prior to auction. We may use this information to provide you with other real estate services including referrals to authorised financial services' providers. Visit our website at www.marshallwhite.com.au for our privacy policy.