



  
MARSHALLWHITE

149A Graham Street  
Port Melbourne





## Contemporary City Chic in Prime Port Melbourne

Behind a striking exterior this contemporary executive townhouse presents light-filled living, lifestyle opportunity and location. Two double bedrooms equipped with built-in robes include a stylish main with balcony complete with rooftop and city skyline views. Open-plan living complete with a sleek kitchen, relaxed dining and sitting areas opens out through full-width bi-fold doors onto a bijou courtyard with retractable awning for year-round entertaining. Polished timber floors, underfloor heating, Euro laundry and clever storage complement this superb setting minutes from cafes, parks, light rail and the beach.

149agrahamstreet-portmelbourne.com

2 1

Auction Saturday 29th April at 10.30am

Michael Paproth 0488 300 800

Scott O'Halloran 0413 464 473

101 Dundas Place Albert Park  
marshallwhite.com.au

  
MARSHALLWHITE

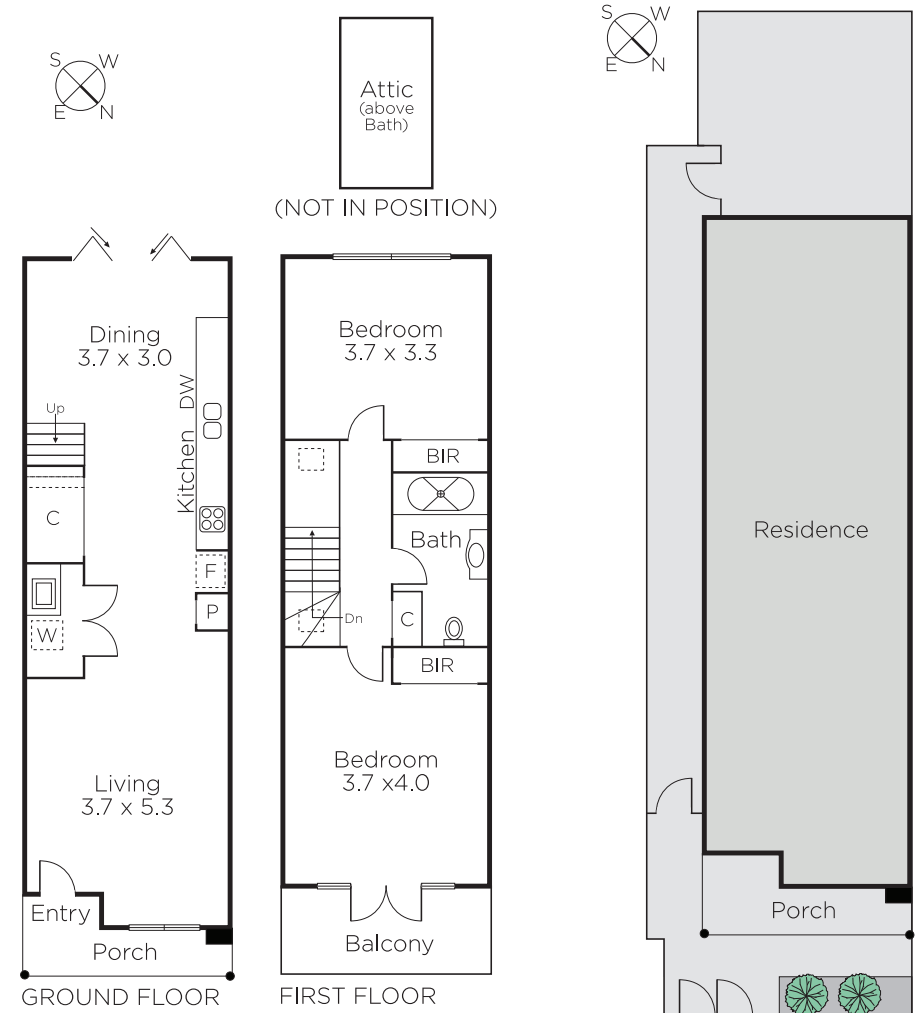

Disclaimer: Information provided is believed to be accurate as at the date of printing, no responsibility is taken for any errors or omissions. It is your responsibility to obtain independent, professional advice. Personal information collected from you is for security purposes and to contact you should the property sell prior to auction. We may use this information to provide you with other real estate services including referrals to authorised financial services' providers. Visit our website at [www.marshallwhite.com.au](http://www.marshallwhite.com.au) for our privacy policy.