



SHERIDAN CLOSE

SHERIDAN CLOSE

  
MARSHALLWHITE  
ONE

14/485-489 St Kilda Road  
Melbourne





## ‘Sheridan Close’: Unique Fawkner Park Perspective

A home like no other, this charming, two bedroom, apartment directly overlooks the beautiful expanses of Fawkner Park and is well-removed from St.Kilda Rd, behind an exquisite street frontage. With lovely parquetry floors throughout, the home’s kitchen is a modern designer domain that connects via a servery to the lounge/dining which frames the most divine, first-floor, views of the park, whilst large mirrored robes in one of the bedrooms is fabulously convenient. Also features an undercover parking space, security door, premium stainless steel kitchen appliances and stone benches as well as a heated towel rail in the bathroom. Enviably positioned on the city fringe, bordering parkland and just around the corner from Chapel St, this diverse and cosmopolitan location is one of Melbourne’s finest...it’s all at your doorstep!

14-485-489stkildaroad-melbourne.com 2 1 1

Auction Saturday 27th May at 12noon

Matthew Grima 0403 438 601

Bradley Steinbach 0403 539 038

101 Dundas Place Albert Park

9822 9999 mwone.com.au

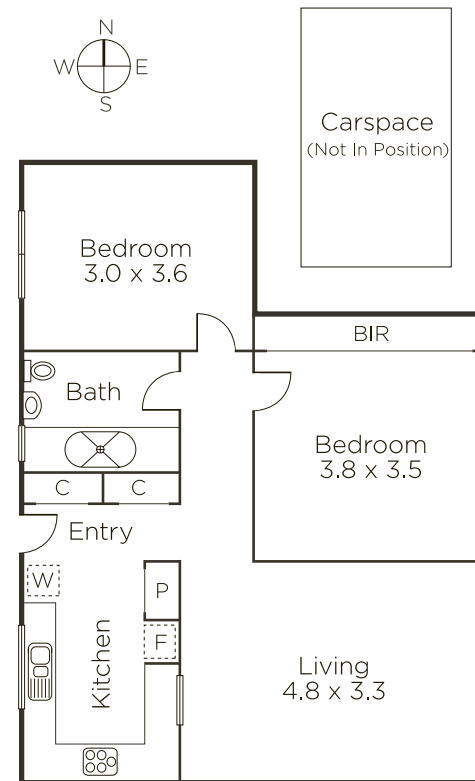

Disclaimer: Information provided is believed to be accurate as at the date of printing, no responsibility is taken for any errors or omissions. It is your responsibility to obtain independent, professional advice. Personal information collected from you is for security purposes to contact you should the property sell prior to auction. We may use this information to provide you with other real estate services including referrals to authorized financial services providers. Visit our website at [www.mwone.com.au](http://www.mwone.com.au) for our privacy policy.