



MARSHALLWHITE  
ONE

14/271A Williams Road  
South Yarra



## Easy Living or Astute Investing in South Yarra

This bright, one bedroom apartment is a wonderfully positioned entry or investment in the streets of South Yarra, well removed from the road and blessed with a broad & bright northern orientation. Capture the significant lifestyle benefits or blue ribbon investment prospects of this exclusive location, in a comfortably presented home that also offers the prospect of a quick cosmetic renewal. The kitchen / meals is removed from a lounge / dining that offers terrific views and glimpses of the peaks of the city skyline, whilst there are robes in the bedroom, fresh carpets, secure intercom entry and laundry facilities. Just a short walk from Chapel St's vibrancy where the cafes, bars, restaurants and strip shopping are peerless and an even shorter walk from the more refined experience of Hawksburn Village, plus you have the Number 58 tram and Hawksburn Railway Station nearby as well.

14-271awilliamsroad-southyarra.com

1 1

Auction Saturday 30th November at 12.30pm

Jack Nicol 0400 774 428

1111 High Street Armadale

Gareth MacLeod 0409 920 553

9822 9999 mwone.com.au

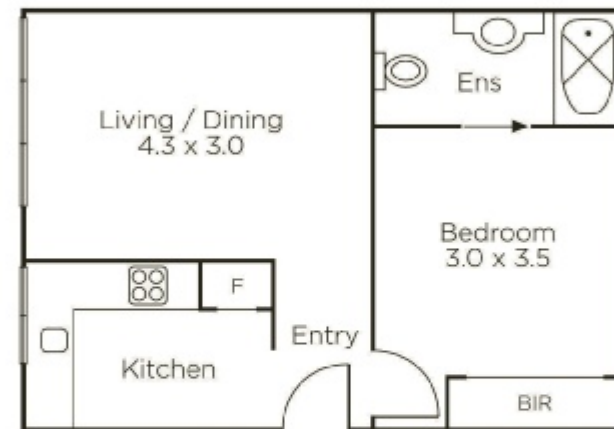

  
MARSHALLWHITE  
ONE

Disclaimer: Information provided is believed to be accurate as at the date of printing, no responsibility is taken for any errors or omissions. It is your responsibility to obtain independent, professional advice. Personal information collected from you is for security purposes to contact you should the property sell prior to auction. We may use this information to provide you with other real estate services including referrals to authorized financial services providers. Visit our website at [www.mwone.com.au](http://www.mwone.com.au) for our privacy policy.