



MARSHALLWHITE

14 Callantina Road
Hawthorn





A House with a Difference

Nestled privately behind a high front fence this Architect designed split-level 1970s contemporary family residence presents an outstanding opportunity to enjoy a sought-after Hawthorn lifestyle in the prestigious Scotch College Hill precinct. The home delivers flexible zoned living areas coupled with scope to update the interior or alternatively a site for the construction of a luxurious new home if desired (STCA). Comfortably appointed, the interior over multiple levels features warm timber and brick surfaces with an upper level formal sitting and dining room with OFP and a balcony with tree-top views across Kooyong to Malvern plus a main bedroom with BIRs & ensuite. Whilst the middle level has a generous informal dining room, modern, well-equipped north-facing kitchen and living area opening to a leafy front garden with a paved outdoor dining area - ideal for indoor/outdoor relaxation and entertaining. Leading to four lower level bedrooms or 3+study, two family bathrooms, a laundry and cellar storage opening to multi-level decks, a north/south half tennis court and a trampoline. Features include intercom entry, gas heating and a double carport+OSP. Land: 780sqm approx.

14callantinaroad-hawthorn.com

5  3  2 

Auction Saturday 26th August at 10.30am

James Tostevin 0417 003 333

Nikki Van Gulick 0419 325 911

James Connell 0418 312 907

801 Glenferrie Road Hawthorn

marshallwhite.com.au

MARSHALLWHITE

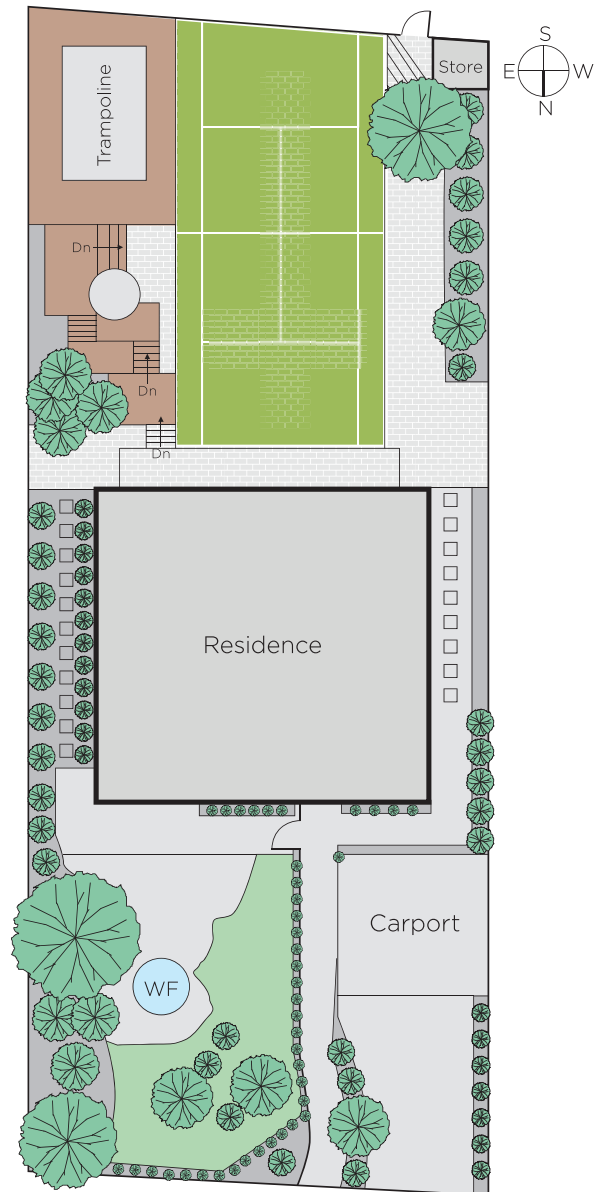
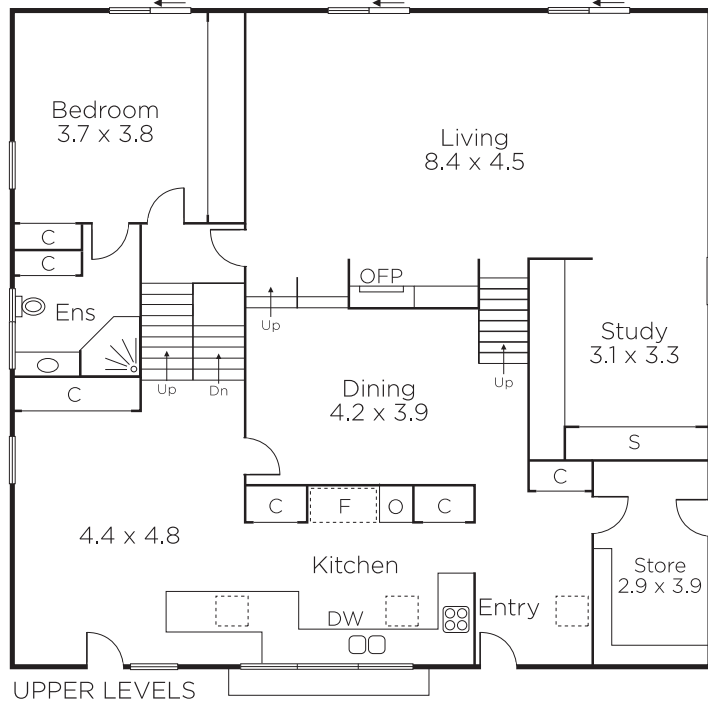
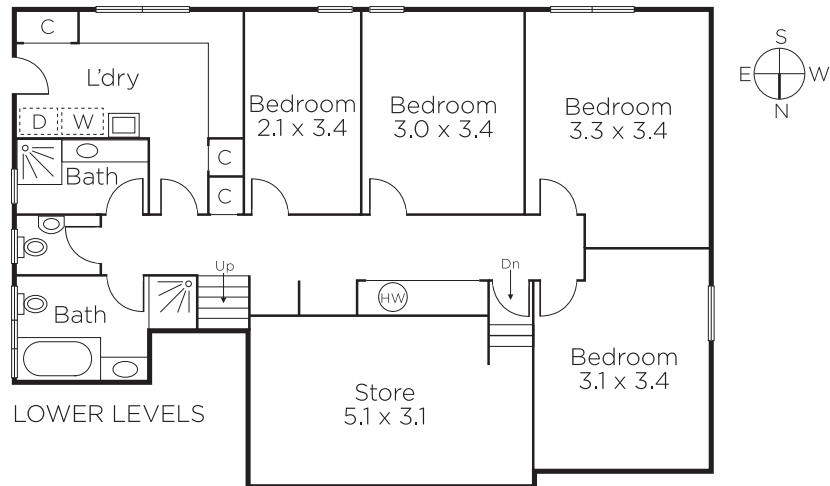

Disclaimer: Information provided is believed to be accurate as at the date of printing, no responsibility is taken for any errors or omissions. It is your responsibility to obtain independent, professional advice. Personal information collected from you is for security purposes and to contact you should the property sell prior to auction. We may use this information to provide you with other real estate services including referrals to authorised financial services' providers. Visit our website at www.marshallwhite.com.au for our privacy policy.