



MARSHALLWHITE
ONE

12/48 Darling Street
South Yarra



Designer Renovation with Superb Views

On the top floor with terrific urban views, this beautifully renovated, three bedroom apartment is a surprisingly spacious home superbly positioned between the premier lifestyle attractions of Toorak Rd, Chapel St and the Yarra River. A tastefully contemporary colour palate and polished timber floors highlight beautiful stone kitchen benches and superior Bosch appliances as the open-plan kitchen/meals/living opens to a north-facing balcony and exposes superb views across the Yarra River. Also impressively renovated, the bathroom/laundry is particularly attractive, whilst carport parking is a brilliant addition in this cosmopolitan location and robes introduce excellent storage to each of the bedrooms. From this iconic address, you can immerse yourself in an incredible selection of local cafes, restaurants and bars, as well as amazing strip shopping, nearby cinemas and all modes of public transport.

12-48darlingstreet-southyarra.com

3 1 1

Auction Saturday 26th August at 1pm

Lewien Gallus 0418 343 908

Bethany Wilkinson 0449 285 813

Matt Giulieri 0407 851 206

1111 High Street Armadale

9822 9999 mwone.com.au

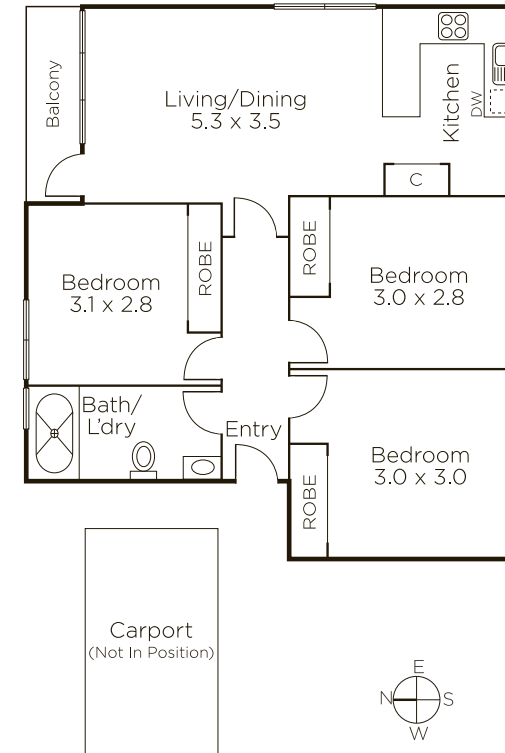

MARSHALLWHITE
ONE

Disclaimer: Information provided is believed to be accurate as at the date of printing, no responsibility is taken for any errors or omissions. It is your responsibility to obtain independent, professional advice. Personal information collected from you is for security purposes to contact you should the property sell prior to auction. We may use this information to provide you with other real estate services including referrals to authorized financial services providers. Visit our website at www.mwone.com.au for our privacy policy.