



120



MARSHALLWHITE

120 Nott Street
Port Melbourne



Delightful Victorian in Prime Location

Desirably situated just moments from the beach, Bay St and the light rail, this charming Victorian residence's superbly presented dimensions deliver immediate lifestyle appeal while also offering scope to further update or extend (STCA). Classic high ceilings provide wonderful period character through the arched entrance hall and two double bedrooms both with open fireplaces and built in robes. The light-filled living room, dining room and stylish kitchen lead to the private garden with off street parking. The bright bathroom includes laundry facilities. The perfect domain to enjoy now while considering future options.

120nottstreet-portmelbourne.com

2 1

Auction Saturday 9th June at 12.30pm

Justin Holod
0411 669 161

Georgia Whitford
0434 827 563

MARSHALLWHITE

101 Dundas Place, Albert Park

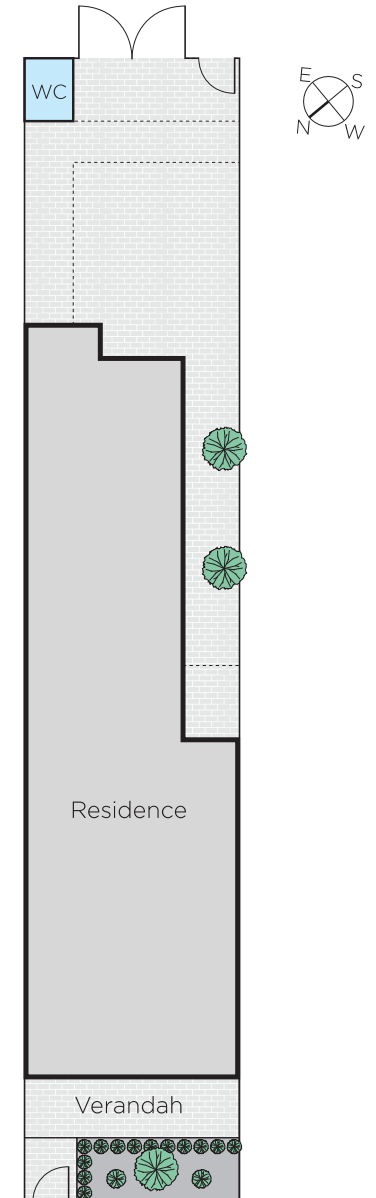
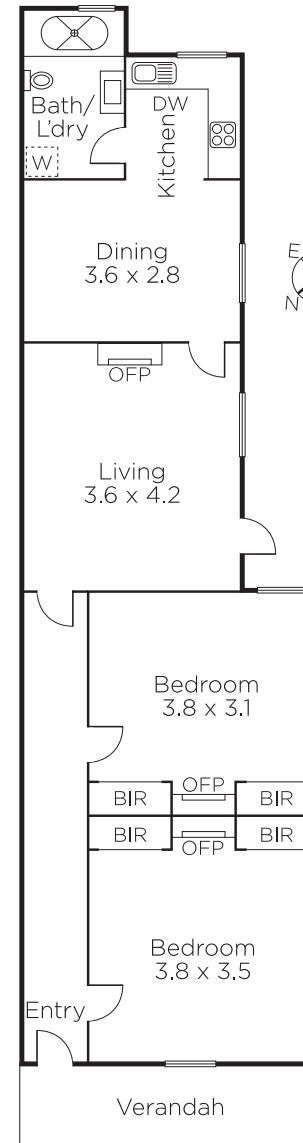

Disclaimer: Information provided is believed to be accurate as at the date of printing, no responsibility is taken for any errors or omissions. It is your responsibility to obtain independent, professional advice. Personal information collected from you is for security purposes and to contact you should the property sell prior to auction. We may use this information to provide you with other real estate services including referrals to authorised financial services providers. Visit our website at www.marshallwhite.com.au for our privacy policy.