

Malvern Residences. Designed by Paul Conrad.

15 Custom-Designed Residences

1188 Malvern Road, Malvern

			
			<p>Fusing simple, clean and finely detailed design, Malvern Residences pays respect to the stately homes speckled throughout the grand avenues and boulevards that distinguish Stonnington as one of Melbourne's most covetable realms. Homes considered to the highest degree are the result, intrinsically created to enhance the lives that will play out within.</p>



The Architect

Paul Conrad

Paul Conrad is the founder of Conrad Architects; an architectural and interior design practice committed to delivering distinctive and timeless design solutions that respond to contemporary living.

With a career established at Woods Bagot, HOK London and Hassell, Paul is celebrated for an exacting approach to the creation of refined, elegant residences that demonstrate his respect for the long tradition of architecture.

Driven by a belief in the power of design to enhance our lives and the cities in which we live, Paul and the Conrad Architects team are recognised as leaders in premier residential development in the City of Stonnington and beyond.

conradarchitects.com





The Building

“Underpinning these homes are themes of linear and restrained design, inspired by vertical proportioning and details belonging to the grand mansions and homes found throughout the City of Stonnington.”

Paul Conrad

Paul Conrad—Conrad Architects





Connecting interiors with the outdoor landscape remained a top priority throughout the design process – natural light fills spaces with high ceilings, maximised as it travels through full-height glazed windows and reflects off bright white walls into joyous spaces.

The Interiors

The way seasons beautifully morph throughout the year is felt within the homes, as generous windows fill spaces with a great deal of natural light and energy. These havens of luxurious rejuvenation incorporate ensuite, walk-in wardrobes, and butler's pantries in selected apartments.





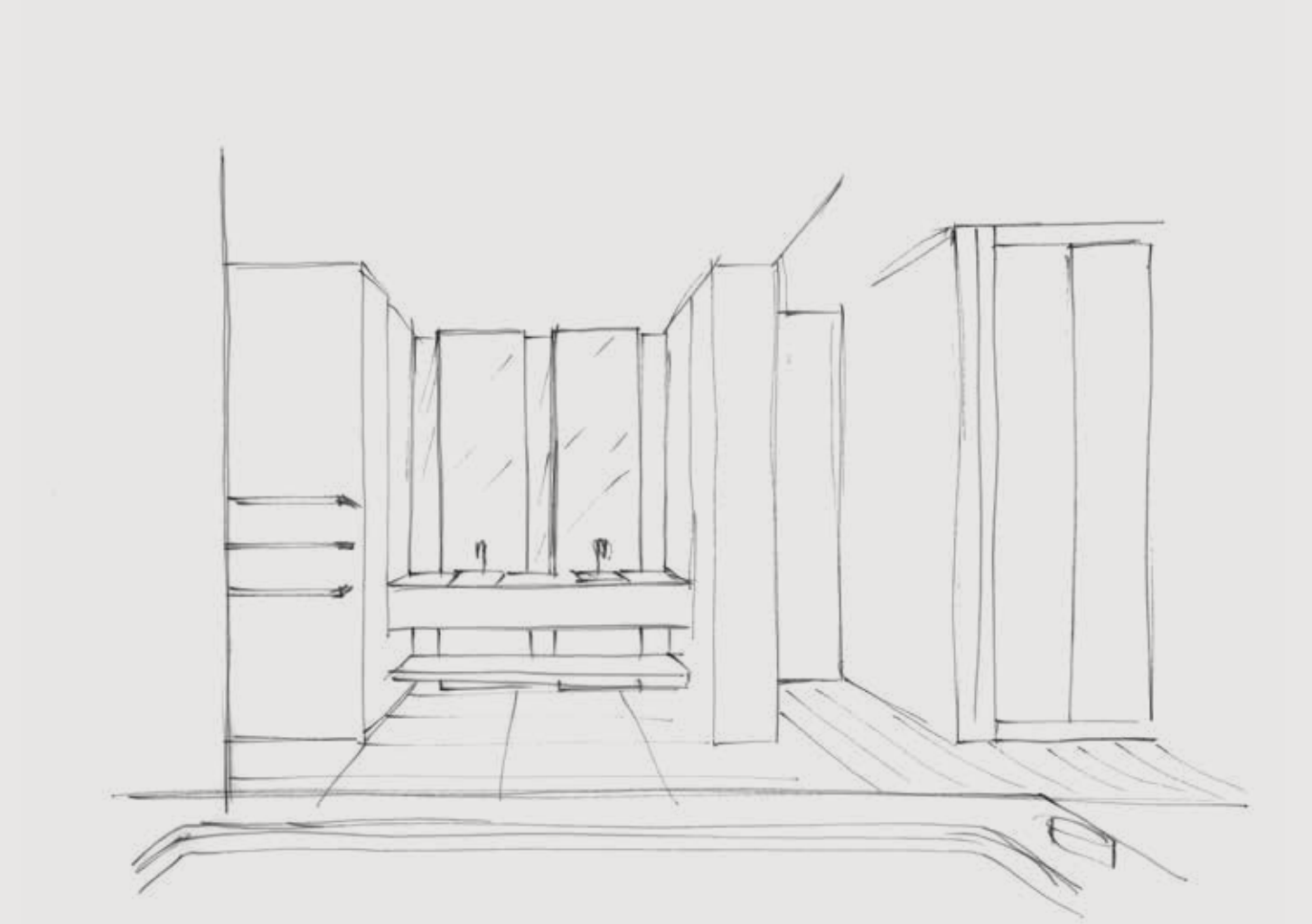
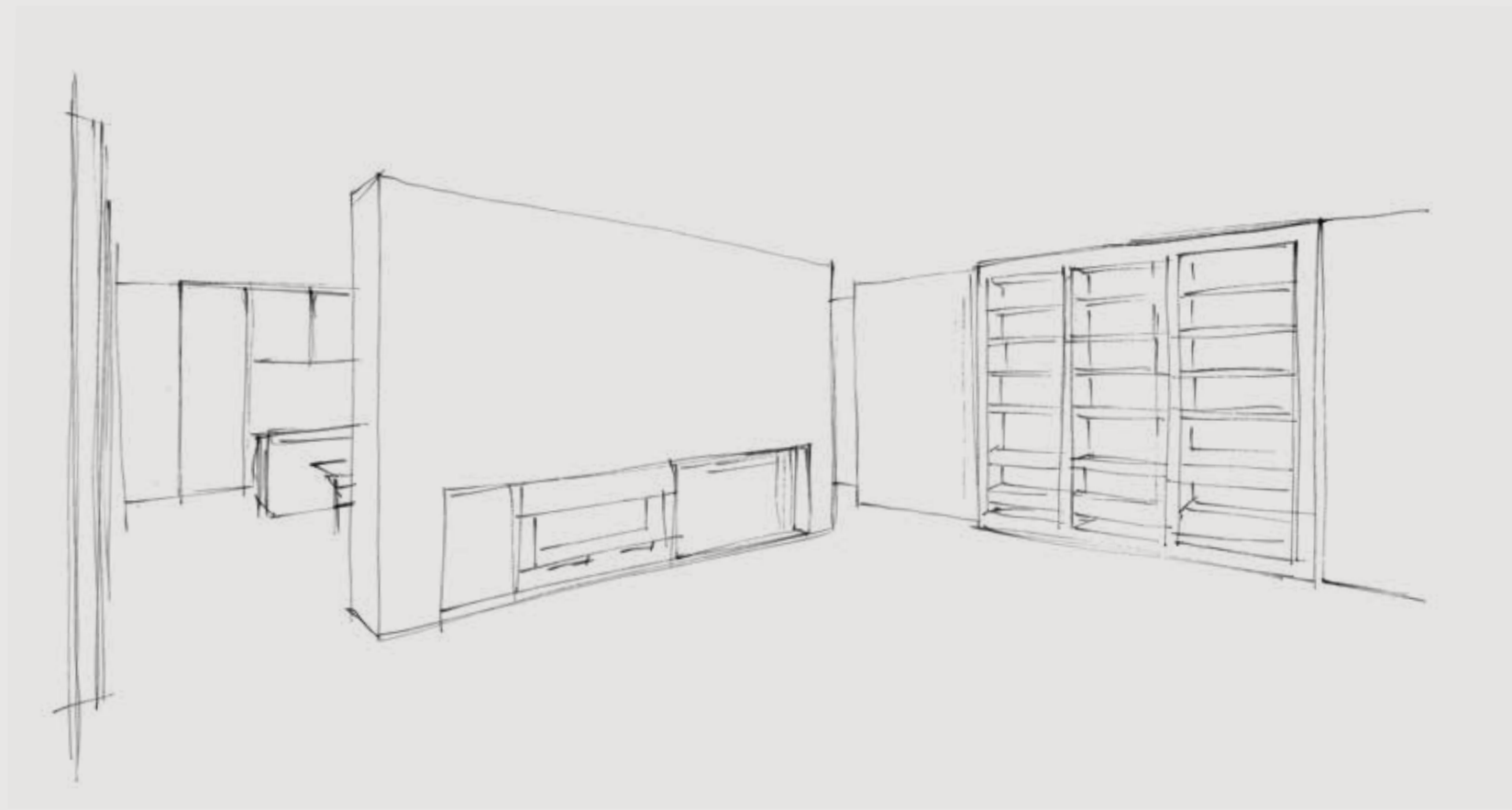

"Malvern Residences is a project that steers away from trends. Clean form design combines with classic materials to make way for homes distinguished by unique spaces."

Paul Conrad—Conrad Architects

The interiors are founded on a contemporary high contrast palette, where light oak floors balance charcoal-coloured panelling to create elegant spaces. Pietra Natuca marble was selected as a stylish highlight, used to form the kitchen and bathroom benchtops.





Grey Porcelain Tile



Pietra Natuca Marble



Timber Flooring



Joinery Finish



Carpet

The Design Process

Inspired by European design, Malvern Residences features a collection of natural, high quality finishes that are not only visually lush, but are also beautiful to touch. Classic proportions are executed with a contemporary feel, as the interplay of high contrast interiors is consistent throughout the project. Light renderings and dark stones work in harmony to create stunning residences that provide brilliant canvases for future homeowners to colour with their favourite artworks and most prized possessions.

At the core of the house, the kitchen is treated with an impeccable level of detail featuring a marble island bench that centres the space, with allocated room for seating to promote interaction among residents and their guests. European appliances from Miele and high-end Australian-made tapware from Brodware raise the space to an inspiring setting, ideal for bringing culinary masterpieces to life.





Bedrooms promote an undeniable sense of comfort through a combination of high ceilings, plush carpeting and walk-in robes, cleanly designed with seamless cupboards and lighting to assist you in selecting an outfit for the day.

A marble-topped vanity bench with an undermount basin is found in Malvern Residences' bathrooms, alongside a white freestanding bath that contrasts with heated towel racks and opulent bronzed tapware.





High Street
& No. 6 Tram

Malvern Public
Gardens

Port Phillip Bay

Chapel Street

St Kilda Road

Malvern Road
& No. 72 Tram

Malvern Road
Village

Glenferrie Road
& No. 16 Tram

Melbourne
CBD (7km)

Toorak Road

Monash Freeway

Malvern
Residences.

Malvern's finest feats of culinary, recreational and educational excellence await you.

Eat and drink

- 01 30 Mill Espresso
- 02 Amaru
- 03 Foxes Den
- 04 Giorgio's
- 05 Le Petit Prince
- 06 Malvern Hotel
- 07 Mammoth
- 08 Milton Wine Shop
- 09 Moby
- 10 Neon Tiger
- 11 Pizza Religion
- 12 Sagra
- 13 Saint James
- 14 Sissi and Co
- 15 The Beatt
- 16 The Pour Kids
- 17 Thread Cafe
- 18 Wine 1160

Shopping

- 19 Acne Studios
- 20 Aēsop
- 21 Aje
- 22 Assembly Label
- 23 Camilla and Marc
- 24 Cannings Free Range Butchers
- 25 Crate Expectations
- 26 Flowers by Flos Florum
- 27 Malvern Central
- 28 Malvern East X-Press IGA
- 29 Malvern Village Pharmacy
- 30 Mecca Cosmetica
- 31 Readings
- 32 Stockland Tooronga Shopping Centre
- 33 Tigeroy
- 34 Turner and Lane
- 35 Zimmermann

Parks and recreation

- 36 Gardiners Creek Reserve
- 37 Happy Melon Studios
- 38 Harold Holt Swim Centre
- 39 Malvern Cricket Ground
- 40 Malvern Library
- 41 Malvern Public Gardens
- 42 Sir Robert Menzies Reserve
- 43 Tooronga Park
- 44 Union Street Gardens

Education

- 45 Armadale Primary School
- 46 Bialik College
- 47 Caulfield Grammar School (Primary)
- 48 De La Salle College
- 49 Lauriston Girls' School
- 50 Loreto Mandeville Hall
- 51 Malvern Central School

Transport

- 52 Armadale Train Station
- 53 Monash Freeway
- 54 No. 6 Tram (High Street)
- 55 No. 16 Tram (Glenferrie Road)
- 56 No. 72 Tram (Malvern Road)
- 57 Toorak Train Station
- 58 Tooronga Train Station

Legend

|||||

Train Line

————

Tram Line

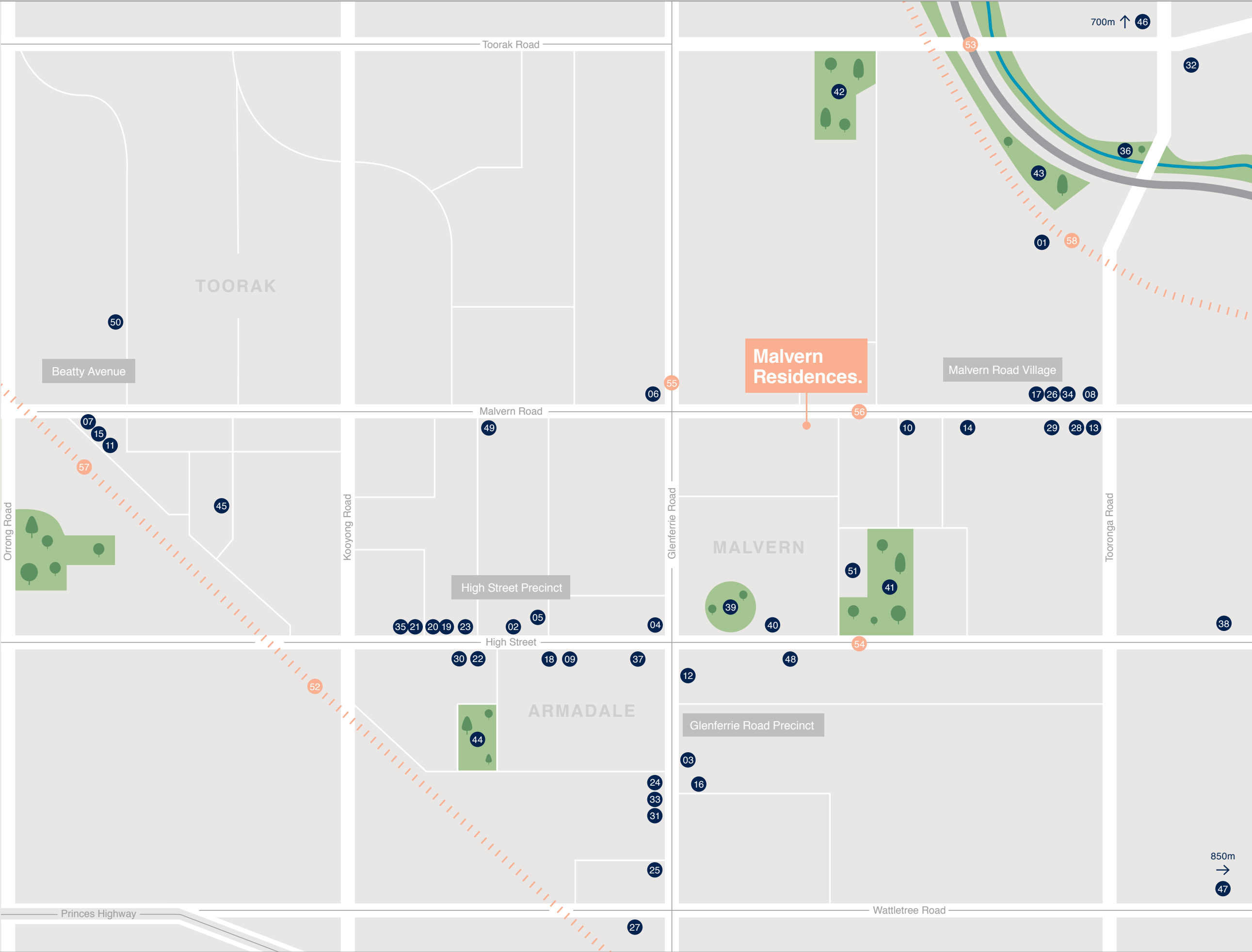



Neon Tiger

This slice of Malvern delivers village style living, turned up a few notches. Malvern Residences' doorstep brims with cafes and eateries perfect for speedy early morning caffeine needs and lengthy weekend brunches.



Sagra



Sissi and Co



Le Petit Prince



Camilla and Marc



Turner and Lane



Flowers by Fios Florum



Aje





Malvern Cricket Ground



Harold Holt Swim Centre



Happy Melon Studios

A Saturday or Sunday may commence with a swim in the glistening outdoor lap lanes of Harold Holt Swim Centre, a yoga class at the bright and beautiful studios at Happy Melon, or hitting some aces at the prestigious courts of Kooyong Lawn Tennis Club.



Malvern Library



No. 72 Tram



Loreto Mandeville Hall



De La Salle College



Tooronga Station

Conrad Architects

Conrad Architects is an architectural and interior design practice committed to delivering distinctive and timeless design solutions that respond to contemporary living. Established by Paul Conrad in 2008, the studio's projects are defined by outstanding quality and a design philosophy that seeks to create a lasting impact through design excellence. Recent projects include Oakdon in Glen Iris, 308 Carlisle, Balaclava, and Meilleur, Malvern.

conradarchitects.com

CONRAD



First Melbourne Developments Group

First Melbourne Developments Group is a well-established property development company specialising in Melbourne's residential apartment and commercial sectors of the market. For over 20 years, the company has been involved in the full spectrum of development projects including high-end residential apartments, townhouses and mixed-use multi-level apartment developments. First Melbourne Developments Group's essential philosophy is founded on seeking out development project opportunities that are unique and distinctive in suburban Melbourne.

firstmelb.com.au



Marshall White Projects

Marshall White Projects has rapidly become one of Melbourne's leading project marketers of residential developments. The company's unmatched, complete and premium service encompasses everything from site selection and negotiation, product design and development, application of current market research and management of your project through to organising a successful delivery of each and every development. Marshall White Projects has managed thousands of successful residential apartment sales and has assisted Marshall White Residential to become Australia's largest privately owned residential sales and marketing agency.

marshallwhite.com.au



Creative by Earl.St

While all reasonable care has been taken in the preparation of this brochure and the particulars contained herein, it is intended to be a visual aid and does not necessarily depict the finished state of the property or object shown. No liability whatsoever is accepted for any direct or indirect loss or consequential loss or damage arising in any way out of any reliance upon this brochure. Purchasers must rely upon their own enquiries and inspections. Furniture is not included with the property. Dimensions and specifications are subject to change without notice. Illustrations and photographs are for presentation purposes and are to be regarded as indicative only. This brochure does not form part of, and is not, an offer or a contract of sale.

Malvern Residences. Designed by Paul Conrad.

malvernresidences.com.au

1188 Malvern Road, Malvern