



MARSHALLWHITE
ONE

1/16 Finlayson Street
Malvern



Unique Al fresco Tranquility

On a generous allotment of beautifully landscaped gardens, this exquisite and refurbished, two bedroom townhouse has been intuitively designed and up-dated to create a seamless connection between indoors and its gorgeous surrounds. Geared for living at ground level, the open-plan kitchen/dining/lounge features a Bosch cooktop and concertina doors that open to introduce a paved courtyard with a retractable awning and an entertainers' deck. Shaded by established trees, the rear garden wraps around to the front which is equally suited to entertaining. The bedrooms are upstairs with robes and the main bathroom is separate to the wc, whilst there is a genuine laundry and under-stair storage, as well as a carport and parking for a second car all behind automatic gates. Central to so much, yet peacefully positioned, this is an excellent first home, investment or down-sizing option near cafes, parks, transport and Malvern Central Shopping Centre.

1-16finlaysonstreet-malvern.com



Auction Saturday 3rd June at 1.30pm

Matt Giulieri 0407 851 206

Clare Moloney 0401 546 441

Joseph Ben-Danan 0408 135 948

111 High Street Armadale

9822 999 mwone.com.au

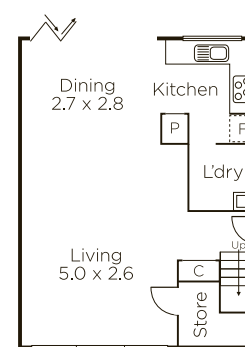

GROUND FLOOR

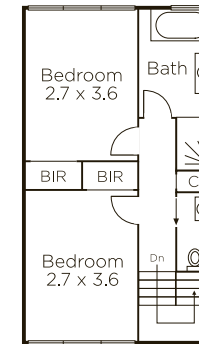

FIRST FLOOR

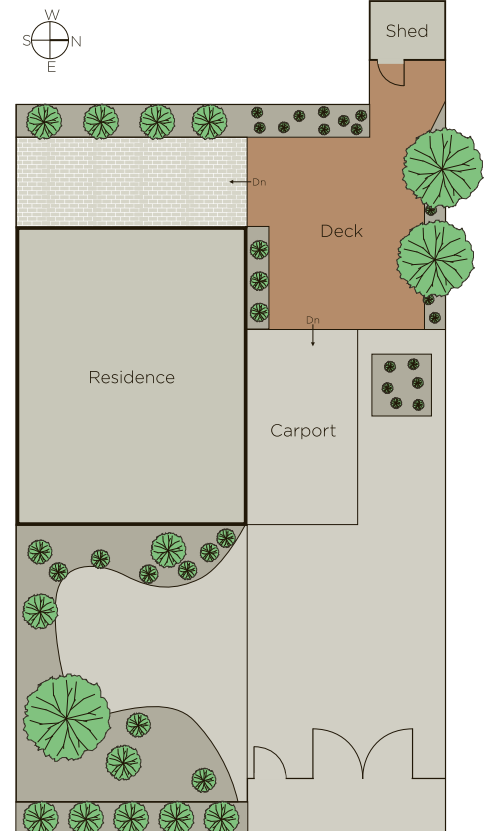

MARSHALLWHITE
ONE

Disclaimer: Information provided is believed to be accurate as at the date of printing, no responsibility is taken for any errors or omissions. It is your responsibility to obtain independent, professional advice. Personal information collected from you is for security purposes to contact you should the property sell prior to auction. We may use this information to provide you with other real estate services including referrals to authorized financial services' providers. Visit our website at www.mwone.com.au for our privacy policy.