



MARSHALLWHITE
ONE

113/311 Burwood Road
Hawthorn



Sleek and Light-Filled Urban Edge

Sleek, sophisticated and absolutely brimming with natural light, this generous, one bedroom apartment offers a premium urban lifestyle or investment just metres from Glenferrie Rd and Swinburne University.

Floor-to ceiling windows and double sliding doors provide a harmonious connection between home's premium-appointed kitchen, open-plan living and a substantial wrap-around balcony, all with sunny northern and westerly orientation. Features a huge bedroom with an alcove study area, as well as secure video entry, basement parking for one car, a storage cage and elevator access.

The lifestyle attractions of this vibrant location are clear. The shops, cafes and terrific restaurants of Glenferrie Rd are just around the corner, whilst such proximity to Swinburne University presents an obvious opportunity for astute investors.

113-311burwoodroad-hawthorn.com

1 1 1

Private Sale

Bethany Wilkinson 0449 285 813
Liam Adey 0432 660 711

801 Glenferrie Road Hawthorn
9822 9999 mwone.com.au

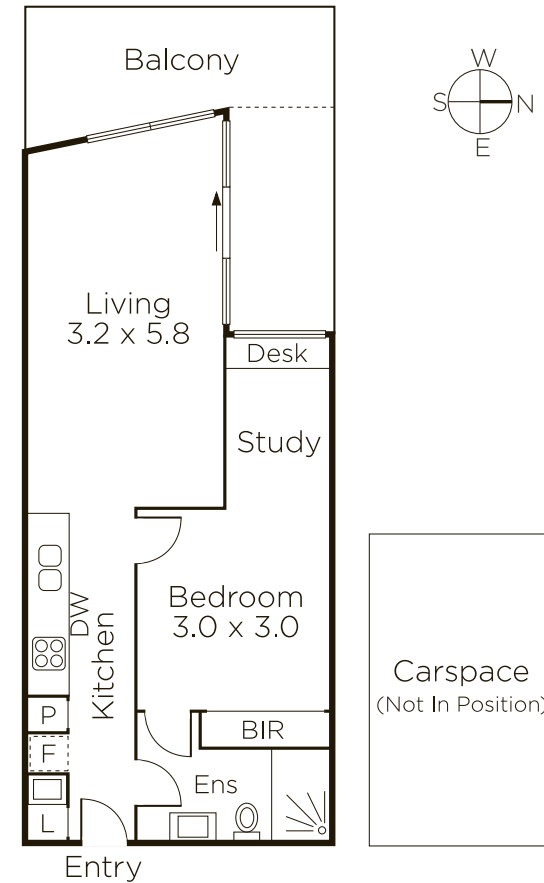

Disclaimer: Information provided is believed to be accurate as at the date of printing, no responsibility is taken for any errors or omissions. It is your responsibility to obtain independent, professional advice. Personal information collected from you is for security purposes to contact you should the property sell prior to auction. We may use this information to provide you with other real estate services including referrals to authorized financial services' providers. Visit our website at www.mwone.com.au for our privacy policy.