



MARSHALLWHITE  
ONE

11/2 Theodore Court  
Toorak





## 'Heyington Gardens': Divine Apartment

Often sought but rarely offered, this generously proportioned and impressively light-filled two bedroom residence is an outstanding opportunity to acquire a quintessentially Toorak apartment with extraordinary fourth floor views in one of the most tightly held cul de sacs in Toorak. Upon entry, the captivating panorama provides a wonderful backdrop to the vast open-plan lounge/dining and balcony which instantly inspires awe, whilst the kitchen is semi-attached to living and equipped with premium European appliances. Mirrored robes and walk-through robes provide excellent bedroom storage and a fully tiled bathroom with corner spa introduces a taste of pure indulgence. Also features intercom entry, elevator access, parking and a powder room. To be so central to everything and yet sufficiently removed is a genuine privilege and you are sure to enjoy the sense of sanctuary whilst being convenient to Toorak Village as well as public transport.

11-2theodrecourt-toorak.com

2 1 1

Auction Saturday 8th July at 10.30am

Matt Giulieri 0407 851 206

Lewien Gallus 0418 343 908

Sam Hobbs 0404 164 444

1111 High Street Armadale

9822 9999 mwone.com.au

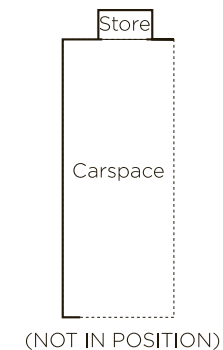
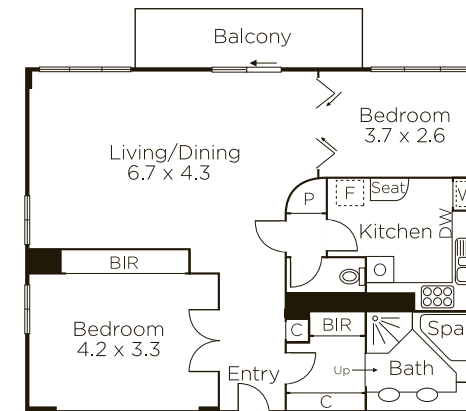

  
MARSHALLWHITE  
ONE

Disclaimer: Information provided is believed to be accurate as at the date of printing, no responsibility is taken for any errors or omissions. It is your responsibility to obtain independent, professional advice. Personal information collected from you is for security purposes to contact you should the property sell prior to auction. We may use this information to provide you with other real estate services including referrals to authorized financial services providers. Visit our website at [www.mwone.com.au](http://www.mwone.com.au) for our privacy policy.