



MARSHALLWHITE  
ONE

11 Fellows Street  
Hughesdale



## A Peaceful Garden Oasis

Remarkably spacious and private, this immaculately presented, two bedroom home is delightfully nestled within its own beautiful, yet low maintenance, garden, to feel like a lovely oasis within walking distance of Chadstone Shopping Centre. Timber benchtops sit tastefully alongside Miele appliances and glass splash backs in an open-plan kitchen/ meals/living that is wonderfully light-filled and flows outside to a paved covered courtyard and pretty backyard. Blessed also with a lovely front garden, the home features a lock-up garage, robes in each bedroom, a laundry and a large bathroom with independent bath and shower that can be accessed directly from one bedroom as an ensuite. Incredibly convenient to shops, cafes and transport, this wonderful oasis is moments from Eaton Mall, Oakleigh where you will find cafes, restaurants and shops, whilst Hughesdale Station and Chadstone Shopping Centre are just around the corner.

11fellowsstreet-hughesdale.com



Auction Saturday 25th November at 9.30am

Joseph Ben-Danan 0408 135 948

Matt Giulieri 0407 851 206

1111 High Street Armadale

9822 9999 mwone.com.au

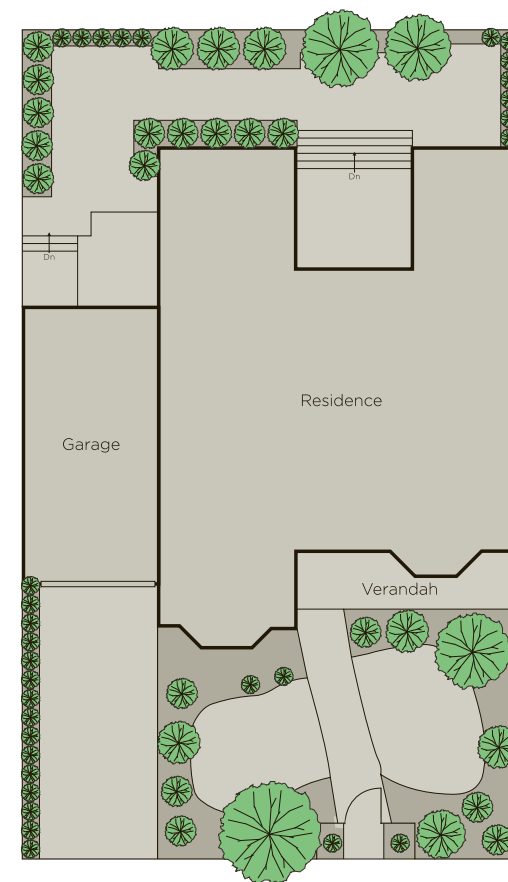
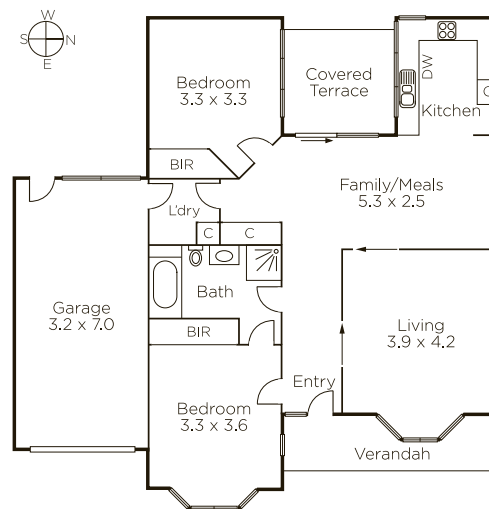

**MARSHALLWHITE**  
**ONE**

Disclaimer: Information provided is believed to be accurate as at the date of printing, no responsibility is taken for any errors or omissions. It is your responsibility to obtain independent, professional advice. Personal information collected from you is for security purposes to contact you should the property sell prior to auction. We may use this information to provide you with other real estate services including referrals to authorized financial services' providers. Visit our website at [www.mwone.com.au](http://www.mwone.com.au) for our privacy policy.