



MARSHALLWHITE

105/33 Wattle Road
Hawthorn



A Stunning Luxuriously Appointed Apartment

This luxuriously appointed apartment features spacious single-level living plus the exclusivity of street frontage and two courtyards - delivering both natural light and indoor/outdoor living & entertaining areas. With a generous living and dining domain incorporating a sleek CaesarStone/Miele kitchen, WIP and a study alcove. Plus a separate laundry, family bathroom and separate bedroom zones, main with WIR/ensuite - both opening to a courtyard. Incls security entry with v/intercom, ducted heating & cooling, high quality fixtures & fittings, sparkling fully-tiled bathrooms plus remote basement garaging (2) and a storage cage.

105-33wattleroad-hawthorn.com



Auction Saturday 24th March at 10am

Tori McGregor
0400 633 992

Michael Wood
0425 280 191



MARSHALLWHITE

801 Glenferrie Road, Hawthorn

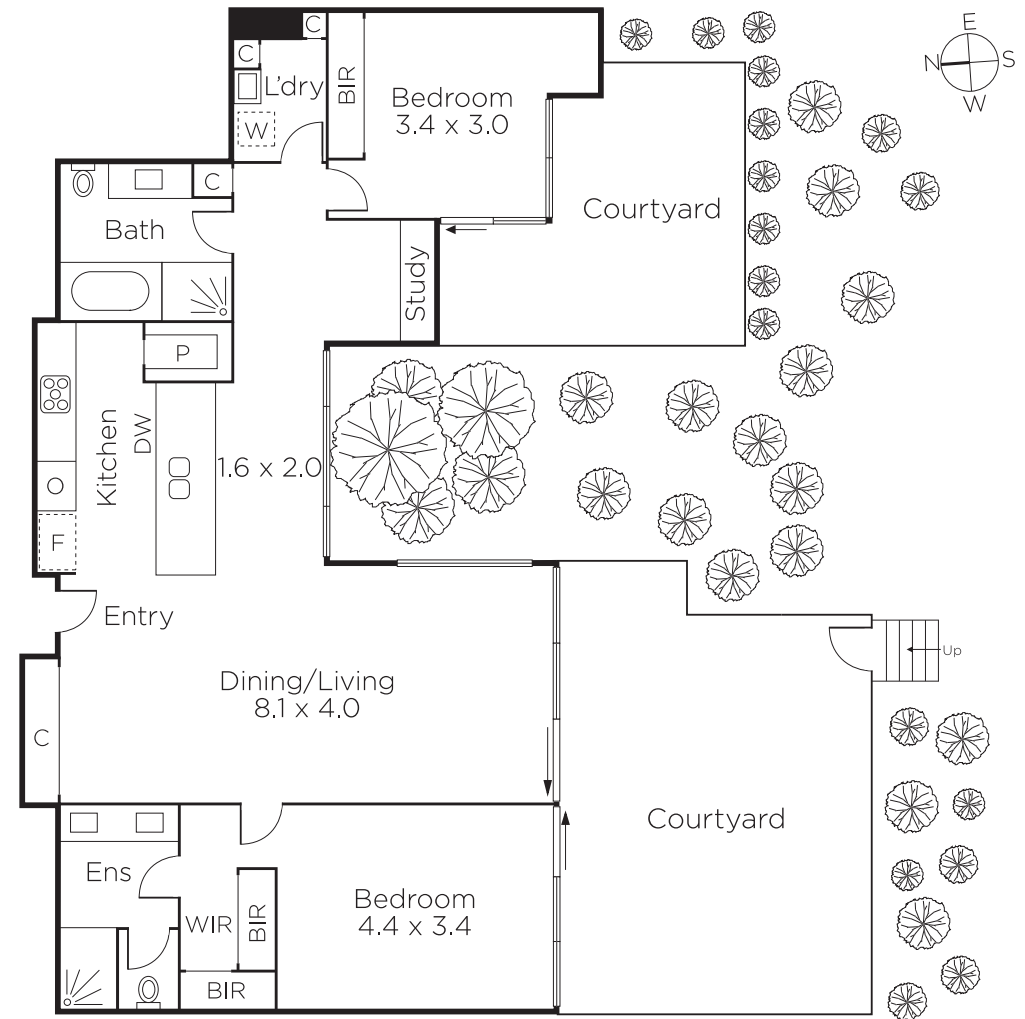

Disclaimer: Information provided is believed to be accurate as at the date of printing, no responsibility is taken for any errors or omissions. It is your responsibility to obtain independent, professional advice. Personal information collected from you is for security purposes and to contact you should the property sell prior to auction. We may use this information to provide you with other real estate services including referrals to authorised financial services providers. Visit our website at www.marshallwhite.com.au for our privacy policy.