



MARSHALLWHITE

10 Queens Square
Sandringham



Queens Square Character and Impressive Potential

Elegant high-set 1890s home on 650sqm approx. is ready to be loved for its updated elegance, 4-bedroom and study design, & an esteemed address near Sandringham Village. 2 living zones, parents' wing with a study/nursery & ensuite, & a north-facing kitchen & dining room, offer single-level spaciousness & restored original features. Contemporary enhancements include plantation shutters, a deck shaded by silver birch trees, security system, heating & cooling throughout & dual-street access. Sought-after location in historical Gypsy Village is an easy walk to the beach, shops, cafes, schools & Sandringham station.

3 2 2

Auction Saturday 8th September at 10.30am

Robin Parker
0409 336 282

Kate Fowler
0418 418 385

Kylie Block
0439 755 588

MARSHALLWHITE

225 Bay Street, Brighton

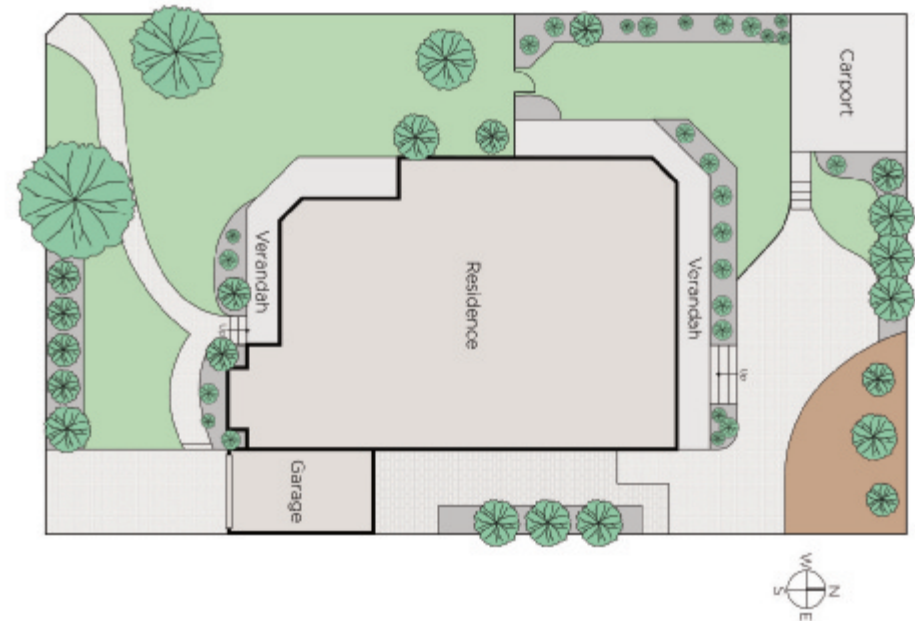

Disclaimer: Information provided is believed to be accurate as at the date of printing, no responsibility is taken for any errors or omissions. It is your responsibility to obtain independent, professional advice. Personal information collected from you is for security purposes and to contact you should the property sell prior to auction. We may use this information to provide you with other real estate services including referrals to authorised financial services providers. Visit our website at www.marshallwhite.com.au for our privacy policy.