



MARSHALLWHITE

10 Hampden Road
Armadale





'Executors Auction' - Exceptional Opportunity, Exclusive Setting

Majestically occupying an outstanding 1158sqm approx. north-west facing private battle-axe allotment, this illustrious period residence of exceptional grandeur represents a once in a generation opportunity to renovate, rebuild or develop in one of Armadale's premier streets just moments from High St's shops and restaurants, Armadale station and schools. Defined by original elegance and substantial proportions, the wide reception hall introduces a generous sitting room with open fireplace and an equally spacious formal dining room, the expansive living and dining room with an open fireplace and well appointed galley kitchen with butler's pantry opens to the sensational private northwest garden offering space for a north-south tennis court and pool. Commanding city views, the second level comprises a main bedroom with en-suite, dressing room and north-facing balcony, additional three double bedrooms with built in robes and a bathroom. A rewarding prospect whichever path is taken, it also includes an alarm, powder-room, laundry and internally accessed double garage.



4  2  2 

Auction Saturday 27th October at 2.30pm

Richard Mackinnon
0414 822 579

Fraser Cahill
0400 592 572

Mark Harris
0414 799 343



MARSHALLWHITE

1111 High Street, Armadale

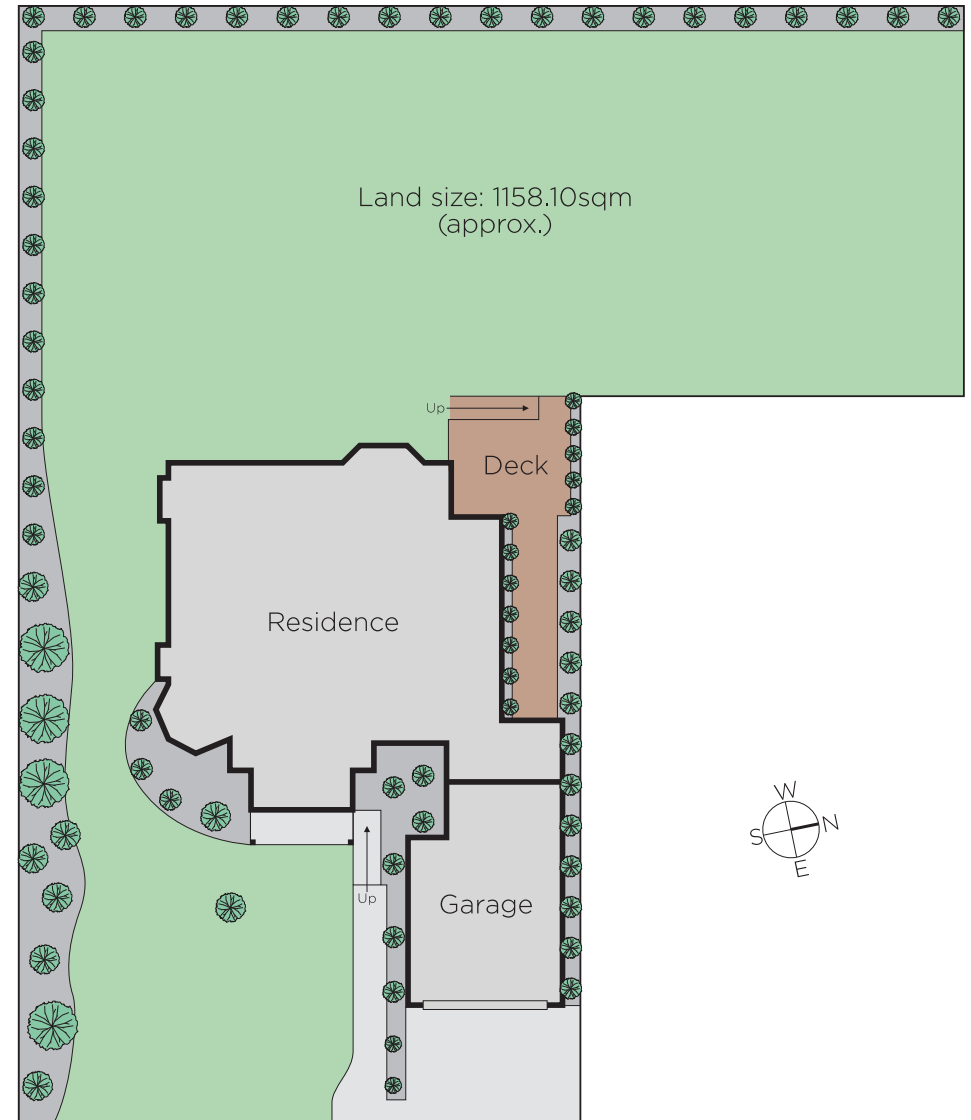
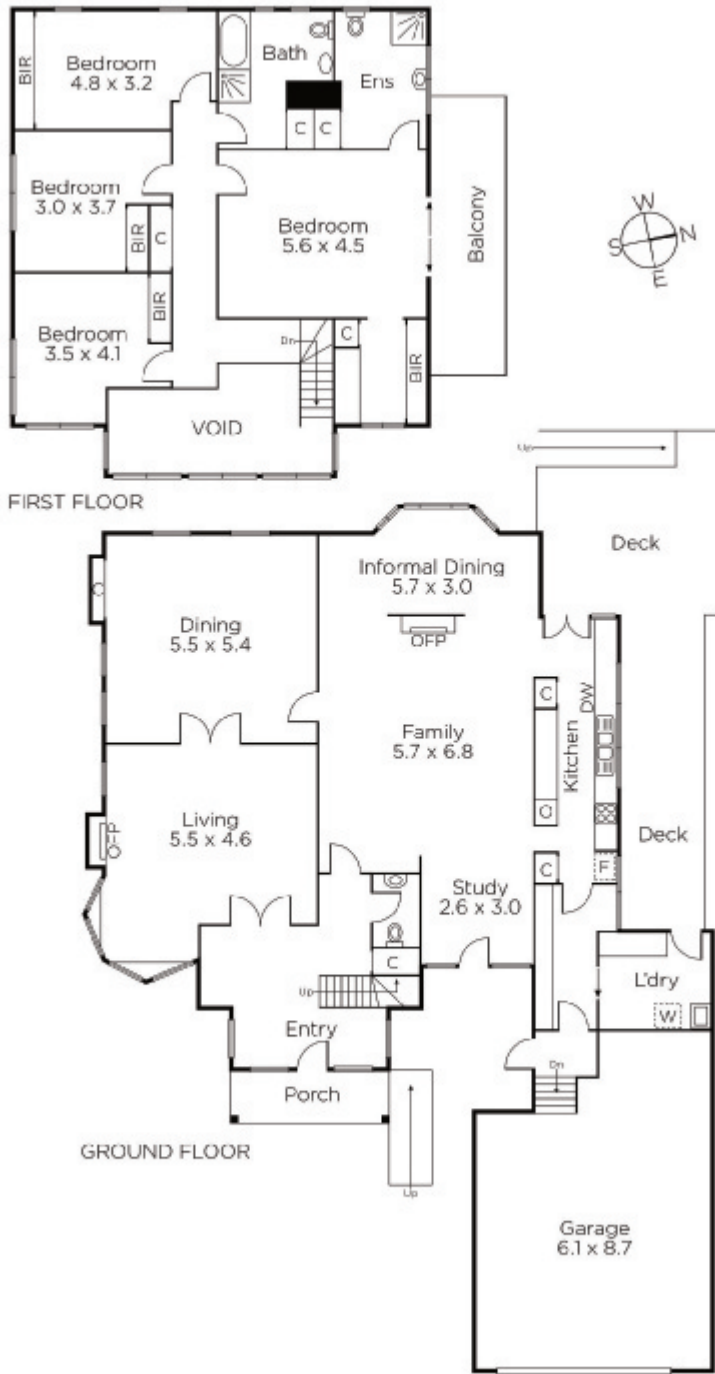

Disclaimer: Information provided is believed to be accurate as at the date of printing, no responsibility is taken for any errors or omissions. It is your responsibility to obtain independent, professional advice. Personal information collected from you is for security purposes and to contact you should the property sell prior to auction. We may use this information to provide you with other real estate services including referrals to authorised financial services' providers. Visit our website at www.marshallwhite.com.au for our privacy policy.