



MARSHALLWHITE

10 Edward Street
Hawthorn



Enviably Location, Enviably Lifestyle

A period streetscape in the heart of Hawthorn minutes to Glenferrie Road & Government, primary & secondary schools adds new meaning to convenience in this desirable, semi-detached Edwardian cottage. Highlighted by a preferred northern aspect which delivers loads of natural light to the interior plus rare tandem OSP in this area. The updated interior features period attributes, 3-bedrooms, full-width living room with cosy fireplace overlooking a sun-drenched, ornamental tree-lined northern garden. A well-equipped kitchen with Euro S/S appliances and dining area leads to a refurbished fully-tiled bathroom/laundry, verandah & courtyard with shed storage.

10edwardstreet-hawthorn.com

3 1 2

Auction Saturday 27th May at 2.30pm

James Tostevin 0417 003 333

Mike Beardsley 0476 777 004

801 Glenferrie Road Hawthorn
marshallwhite.com.au

MARSHALLWHITE

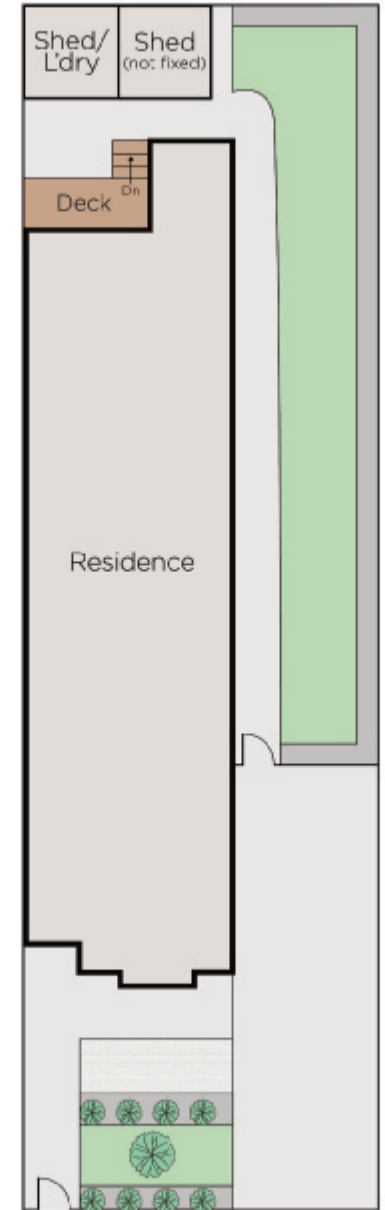
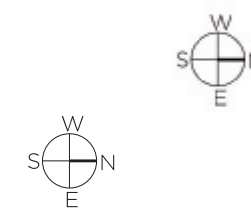
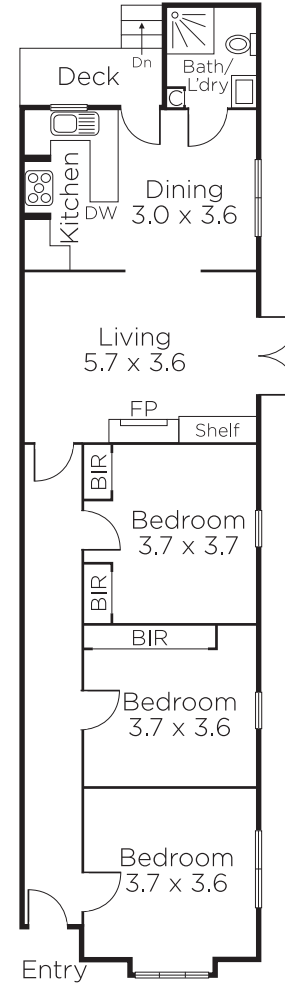

Disclaimer: Information provided is believed to be accurate as at the date of printing, no responsibility is taken for any errors or omissions. It is your responsibility to obtain independent, professional advice. Personal information collected from you is for security purposes and to contact you should the property sell prior to auction. We may use this information to provide you with other real estate services including referrals to authorised financial services' providers. Visit our website at www.marshallwhite.com.au for our privacy policy.