



MARSHALLWHITE

1 Rathmines Road
Hawthorn East



A Super Starter meets Convenience Plus

Following recent refurbishing this well-presented brick Edwardian semi-detached cottage offers an exciting opportunity to secure a period home in an ultra-convenient location close to the eclectic Auburn Village. The interior features Baltic Pine floors flowing through a timber fretwork arched L-shaped entrance hall, past two front bedrooms, main with BIRs, a generous living room through to a stylish kitchen and meals area with charcoal grey cabinetry, Smeg S/S stove and Dishkex dishwasher plus a bathroom with separate WC and laundry. All leading to a private north-facing brick paved courtyard.

2 1

Auction Saturday 15th December at 10.30am

Andrew Gibbons
0407 577 007

Davide Lettieri
0414 018 707

Ellie Scala
0433 356 342

MARSHALLWHITE

801 Glenferrie Road, Hawthorn

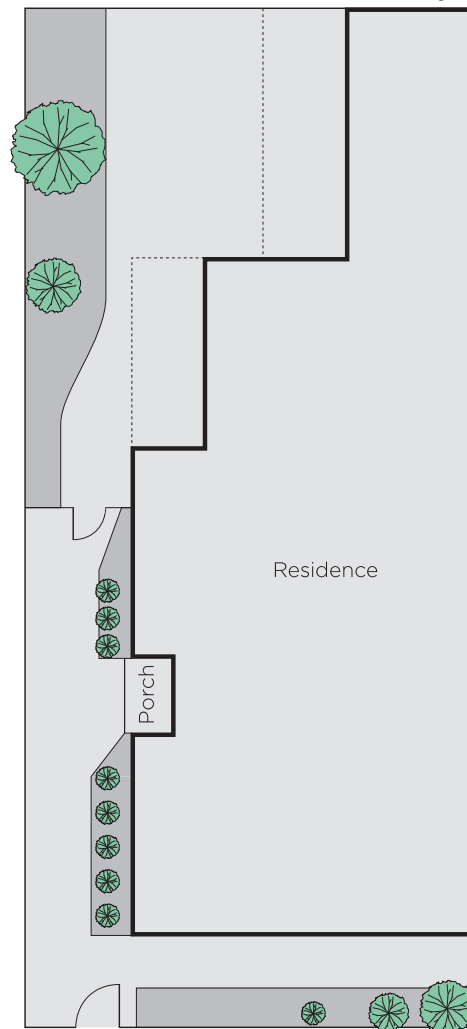
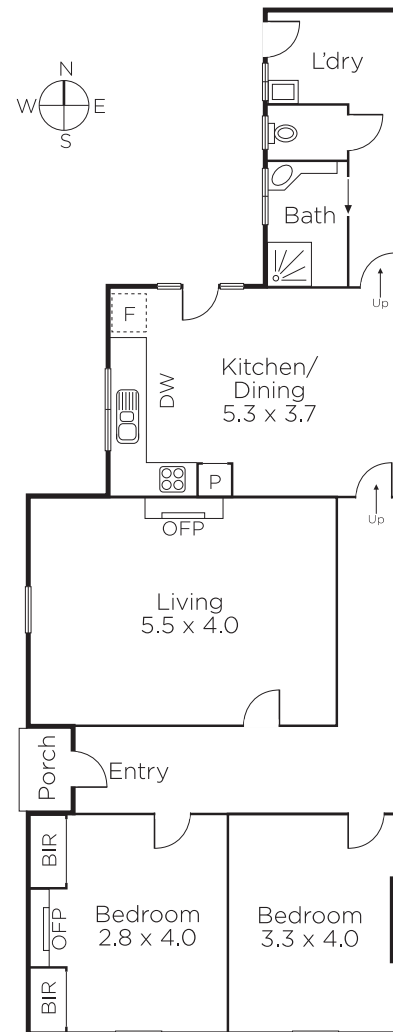

Disclaimer: Information provided is believed to be accurate as at the date of printing, no responsibility is taken for any errors or omissions. It is your responsibility to obtain independent, professional advice. Personal information collected from you is for security purposes and to contact you should the property sell prior to auction. We may use this information to provide you with other real estate services including referrals to authorised financial services providers. Visit our website at www.marshallwhite.com.au for our privacy policy.